

# US-12 (Michigan Avenue) Project Community Meeting

I-96 to Campus Martius Park

April 16, 2025



**TAKE PART**  
Opportunity Rising



*Credit: Christine Ferretti*

# Agenda



**Hear from both city  
and MDOT staff**



**Hear about feedback to  
date, design updates  
and next steps**



**Question and  
answer session**

# What is the Project?



— City of Detroit Segment: Cass Avenue to Woodward Avenue

— MDOT Segment: I-96 to Cass Avenue

Planning and environmental linkages (PEL) study conducted 2019 - 2022 that established the project's purpose and need statement:

“To create a corridor that promotes safe and equitable access to all forms of mobility and emerging technology along Michigan Avenue, while preserving the area's unique character.”

# Summary of Feedback: City Segment

- Extend bike lanes east of Cass Avenue and separate them physically from traffic.
- Make it easier and safer for people to walk along and across Michigan Avenue.
- Maintain valet parking areas and provide flexibility for busy event days, weekends, etc.
- Accommodate heavy bus activity between Washington Boulevard/Cass Avenue and accessing the Rosa Parks Transit Center.
- Accommodate emergency response vehicles throughout segment.
- Consider special event traffic and morning/evening rush hours.

## Meetings to date:

**September 2024** Community Meeting

**November 2024** Stakeholder Meeting

**December 2024** Community Meeting

**March 2025** Stakeholder Meeting



## Preferred Alternative: City Segment

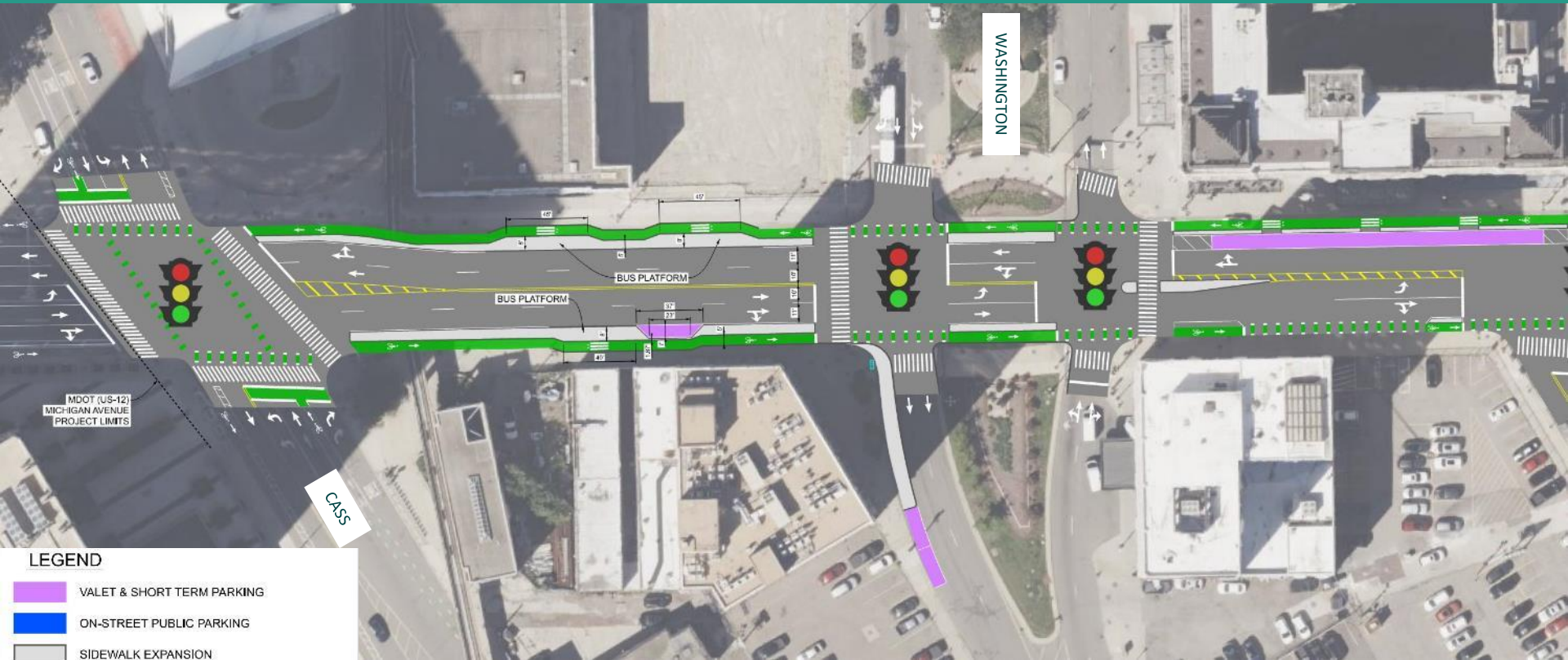

### LEGEND

- |  |   |
|--|---|
|  | VALET & SHORT TERM PARKING                    |
|  | ON-STREET PUBLIC PARKING                      |
|  | SIDEWALK EXPANSION                            |
|  | BARRIER FOR PEDESTRIAN & BIKE LANE PROTECTION |
|  | BIKE LANE                                     |
|  | RAIN GARDEN                                   |

# Preferred Alternative: City Segment

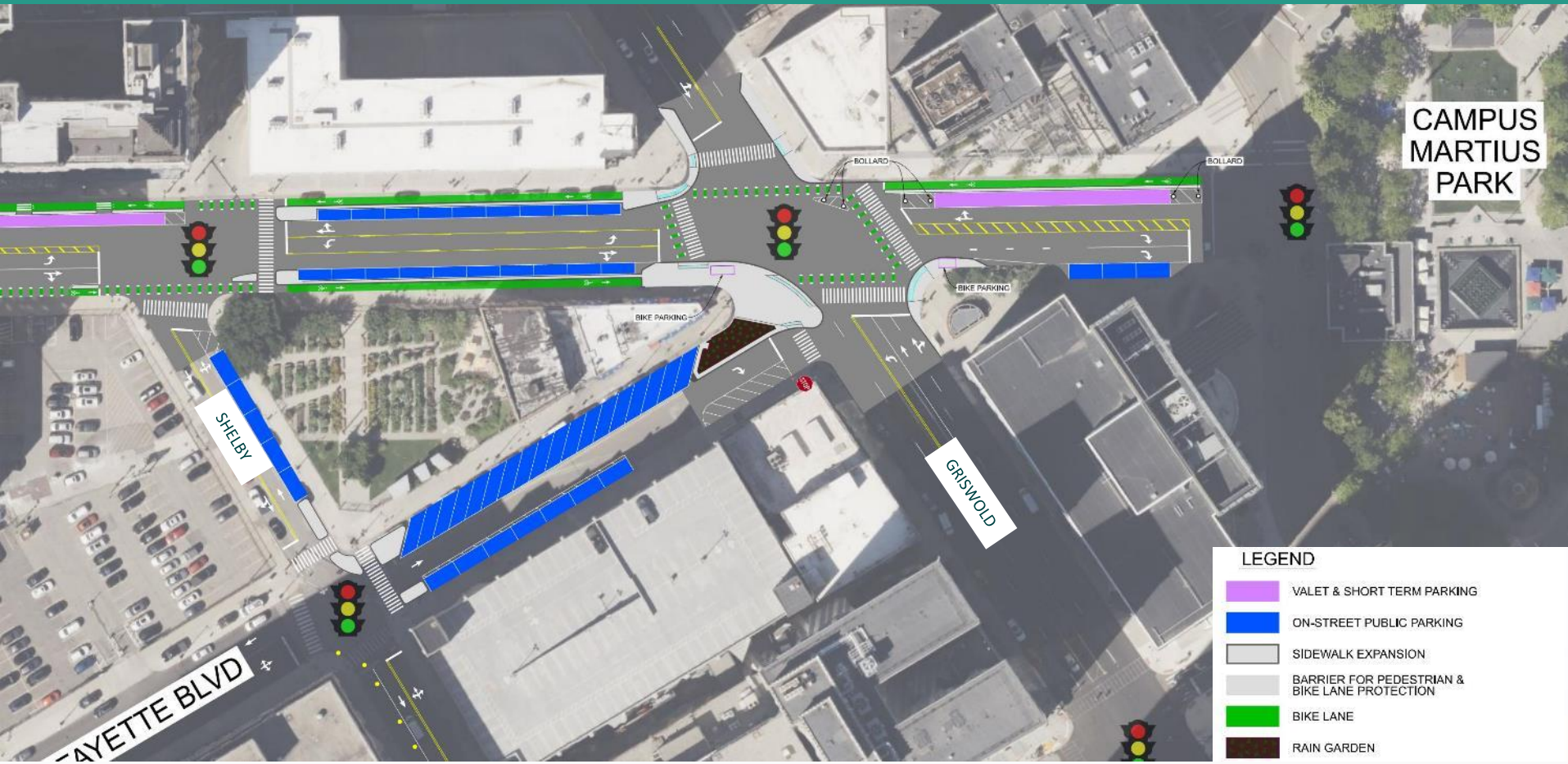

# Project Goals: City Segment

## This Alternative Attempts to:

- Improve safety for all modes
- Avoid impacts on parking, deliveries, valet and access
- Create spaces for landscaping, amenities and beautification
- Prioritize safe and effective avenues for emergency vehicles
- Create a smooth transition from the MDOT segment

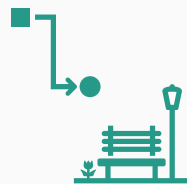

# Next Steps: City Segment

	2024								2025												2026
	MAY	JUN	JUL	AUG	SEP	OCT	NOV	DEC	JAN	FEB	MAR	APR	MAY	JUN	JUL	AUG	SEP	OCT	NOV	DEC	
Data Collection																					
Design Concept Development																					
Final Design																					
Stakeholder Engagement																					
Construction																					



Letting

## Next 90 Days

- Stakeholder engagement
- Coordination with MDOT on joint design/construction
- Continue final design development

## DWSD Construction

- Work beginning in August 2025
- Work includes water main replacement at locations along Michigan Avenue and Fort Street



# Michigan Avenue Innovation Corridor

## Selected Road Section at an Intersection

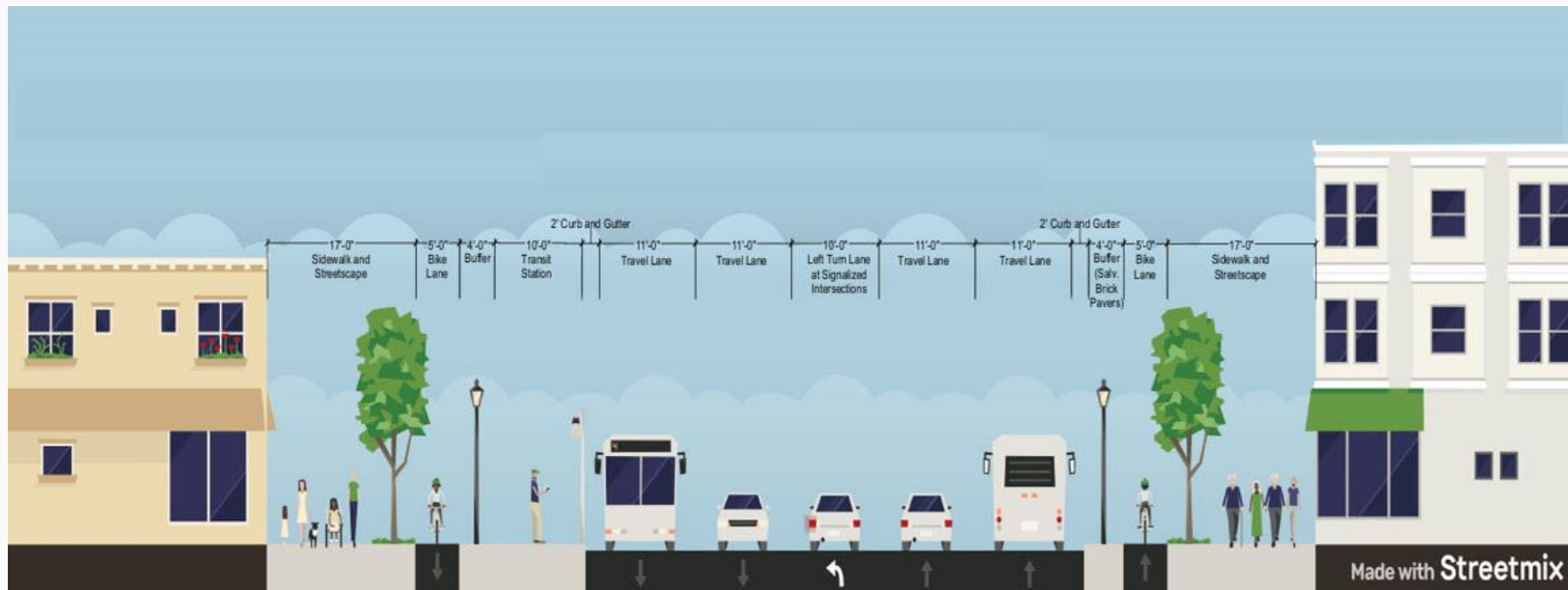

# Michigan Avenue Innovation Corridor

## Selected Road Section at a Mid-Block Crossing

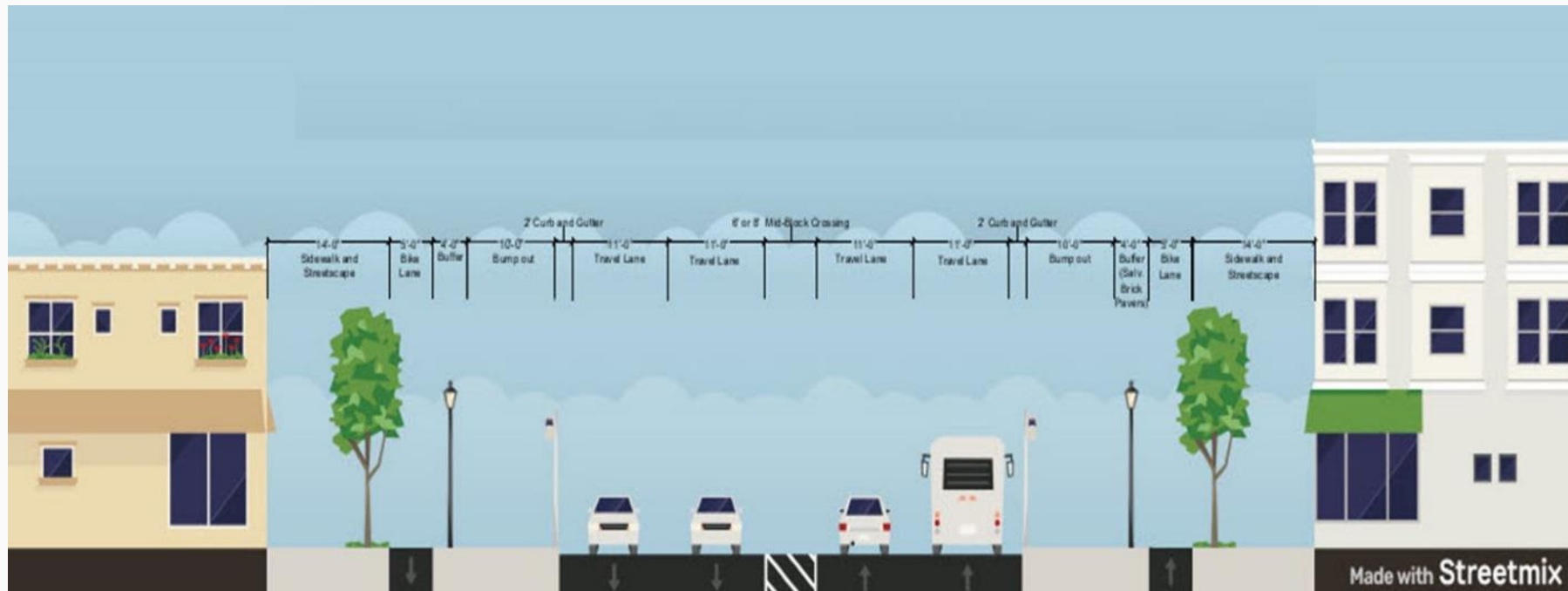

# Michigan Avenue Innovation Corridor



**Vulnerable  
Road User  
Safety**



**Vehicle  
Safety**



**Accessibility  
and  
Community**



**Economic  
Vitality**

# Michigan Avenue Innovation Corridor

## Activities Overview

Several categories of user needs were identified early on:

- Commercial Needs
- Transit Operations Needs
- Signal Operations Needs
- Vulnerable Road User Needs
- Community and Outreach Needs
- Complete Journey Experience Needs
- Parking Needs
- Electrification Needs

Stakeholder task forces were formed for each of these needs categories, focusing on solution recommendations that aligned with constituent priorities.



# Michigan Avenue Innovation Corridor

## Proposed Solutions



Traveler  
Information



V2X

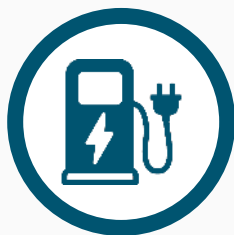

Electrification



Zoning



Signal  
Optimization



App Data  
Integration



VRU  
Protections



Microfreight



AVs

# Michigan Avenue Innovation Corridor

## Solution Highlights

- **Deployment of V2X Solutions**

Identified as a family of ITS solutions with broad applicability and high potential across commercial, transit, signals, and VRU safety use cases.

- **Pedestrian/VRU Protection Solutions**

Highlighted for possible ripple effects, as any positive improvement to VRU safety will also benefit large vehicles with large blind spots like commercial and transit vehicles, as well as overall community safety.

- **Creative Solutions to Parking**

Creation/repurposing of off-street parking for public use was proposed by several task forces.

# Michigan Avenue Innovation Corridor

## Solution Timeline

### Short-Term Solutions (Within Project)

- VRU safety alerting and near-miss detection solutions.
- Signal optimization technologies to improve safety and efficiency.
- Logistical zoning solutions to solve parking demand and congestion from commercial vehicle loading/unloading.
- Integration of Detroit parking app to include new Michigan Avenue parking areas and improve travel route recommendations.
- Installation of EV charging solutions in parking spaces and roadway.
- V2X applications for both safety alerts and fleet use cases.

# Michigan Avenue Innovation Corridor

## Solution Timeline

### Long-Term Solutions (Beyond Project)

- Deployment of automated vehicle fleets.
- Deployment of microfreight delivery solutions.
- Integration of data from other apps and sources to enhance the traveler information sharing experience.
- Expanded use cases for V2X applications.

**Foundational requirements** for both short- and long-term solutions will be identified so that today's Michigan Avenue project can lay the foundation for more futuristic solutions.



# Michigan Avenue Innovation Corridor

## Bike Lane Color Alternatives



# Michigan Avenue Innovation Corridor

## Mid-Block Pedestrian Signal Alternatives



**High-Intensity Activated  
Crosswalk (HAWK)**



**Traditional Signal**



**Rectangular Rapid Flashing  
Beacon (RRFB)**

# Michigan Avenue Innovation Corridor

## Salvaged Brick Alternatives

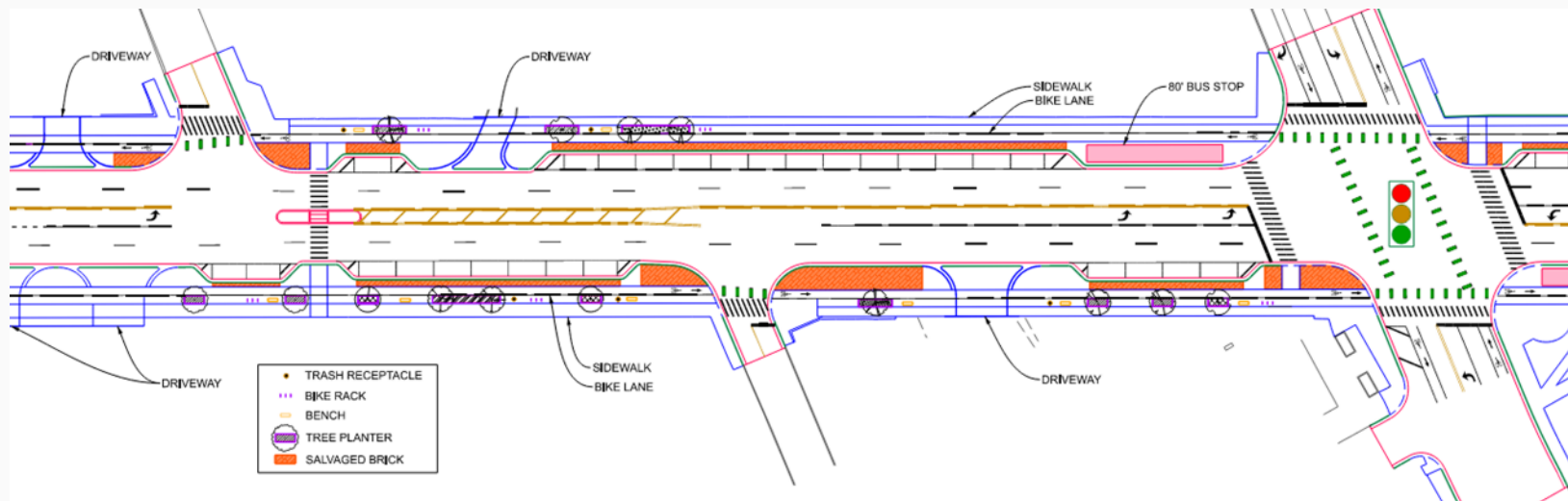

**Salvaged brick in select buffer zones and curb extensions**

# Michigan Avenue Innovation Corridor

## Salvaged Brick Alternatives

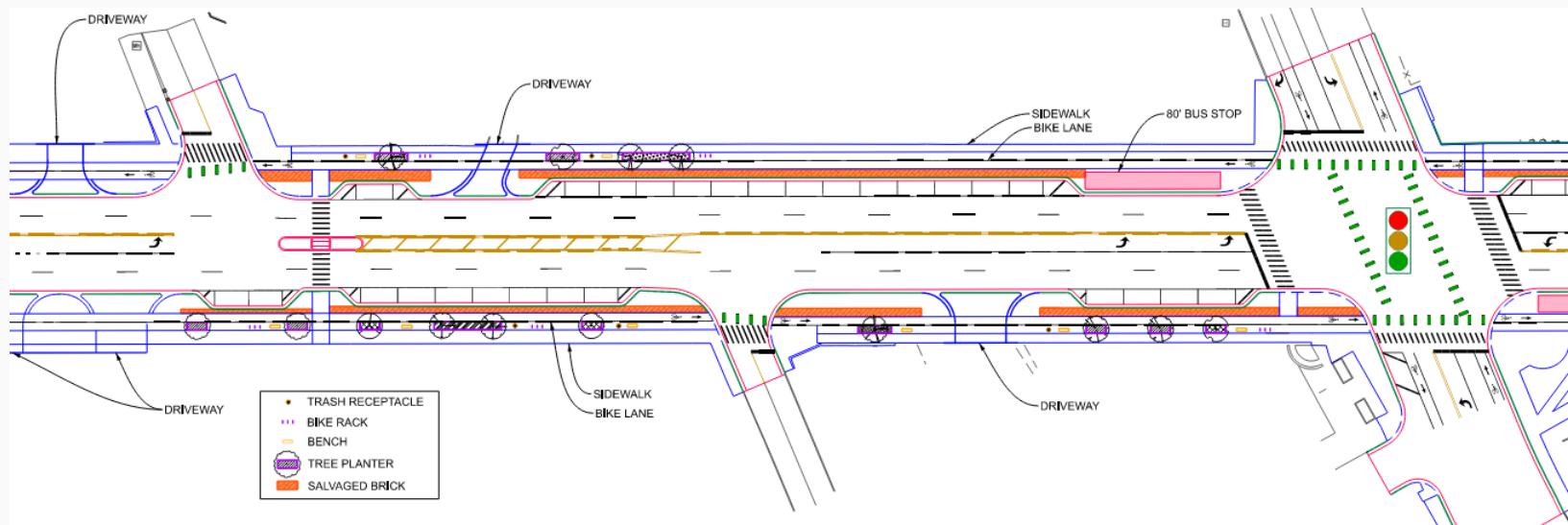

**Brick in select buffer zones**



# Michigan Avenue Innovation Corridor

## Salvaged Brick Alternatives

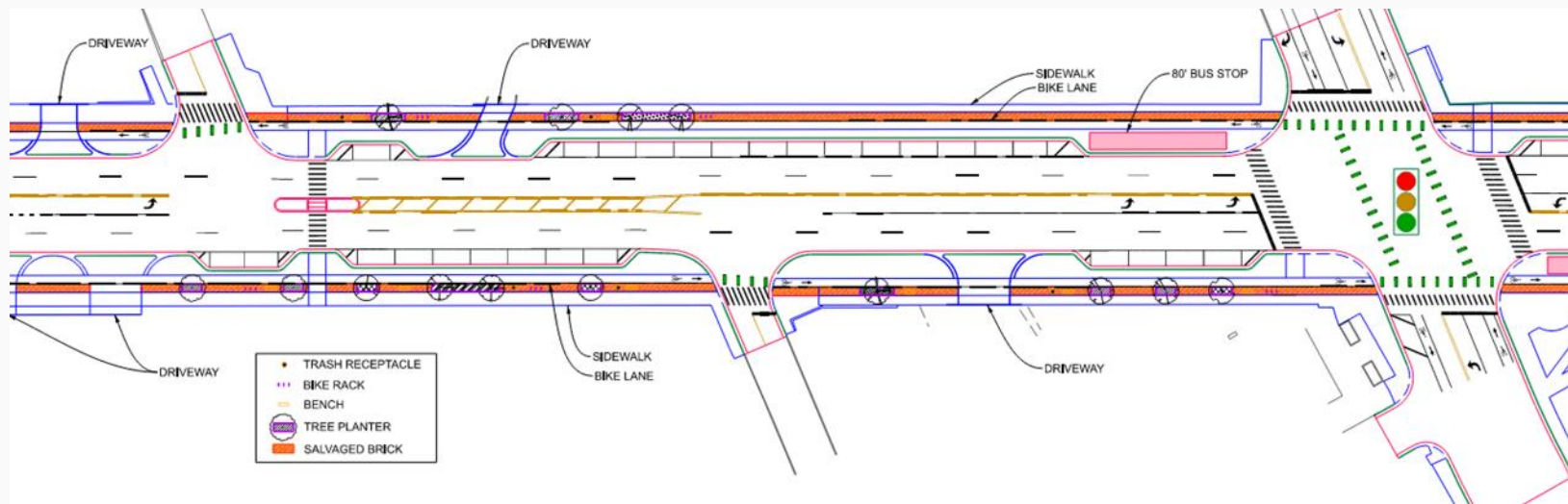

**Salvaged brick between sidewalk and bike path**

# Michigan Avenue Innovation Corridor

## Site Furnishings/Amenities



**Benches**



**Trash Can**



**Bike Rack**

## Have a Comment?

Place your completed comment form in the comment box (located in the meeting room).

Unable to fill it out tonight? Please email your comments to either:

- Augusta Gudeman (Detroit DPW)  
**augusta.gudeman@detroitmi.gov**
- Andrea Wilcox (MDOT)  
**WilcoxA2@Michigan.gov**

# Michigan Avenue Project

Please indicate which segment your comment pertains to:

☐ I-96 to Cass Avenue (MDOT Segment)

☐ Cass Avenue to Campus Martius Park (City of Detroit Segment)

The City of Detroit Department of Public Works (DPW) and the Michigan Department of Transportation (MDOT) have begun planning and design work on the Michigan Avenue project between I-96 and Campus Martius Park. MDOT's limits are from I-96 to Cass Avenue, while the City of Detroit's limits are from Cass Avenue to Campus Martius Park. The project will create a corridor that promotes safe and equitable access to all forms of mobility along Michigan Avenue while preserving the area's unique character. Construction on Michigan Avenue is estimated to begin in 2026 and to be completed in 2027.

Please use this form to provide the City of Detroit and MDOT with your comments by:

- Dropping it into the comment box
- Emailing your comments to:  
[Augusta Gudeman@Detroitmi.gov](mailto:Augusta.Gudeman@Detroitmi.gov)  
and [WjlcovA2@Michigan.gov](mailto:WjlcovA2@Michigan.gov)

Name (Please Print): \_\_\_\_\_

Date: \_\_\_\_\_

Address: \_\_\_\_\_

Organization: \_\_\_\_\_

Email Address: \_\_\_\_\_

**Comments:**

Write on the back or use additional pages if necessary.

---

---

---

---

---

---

---

---

---

---

---

---

---

---

---



---

---

---

---

Thank you!



**Thank You!**

**Augusta Gudeman, MURP, MPP**

Freight Infrastructure Specialist

City of Detroit | Department of Public Works

[Augusta.Gudeman@detroitmi.gov](mailto:Augusta.Gudeman@detroitmi.gov)

**Andrea Wilcox, P.E.**

Project and Contracts Administration Engineer

Detroit Transportation Service Center

Michigan Department of Transportation

[WilcoxA2@Michigan.gov](mailto:WilcoxA2@Michigan.gov)



**TAKE PART**  
Opportunity Rising