

BAD AXE, ENGLER FIELD (E53)

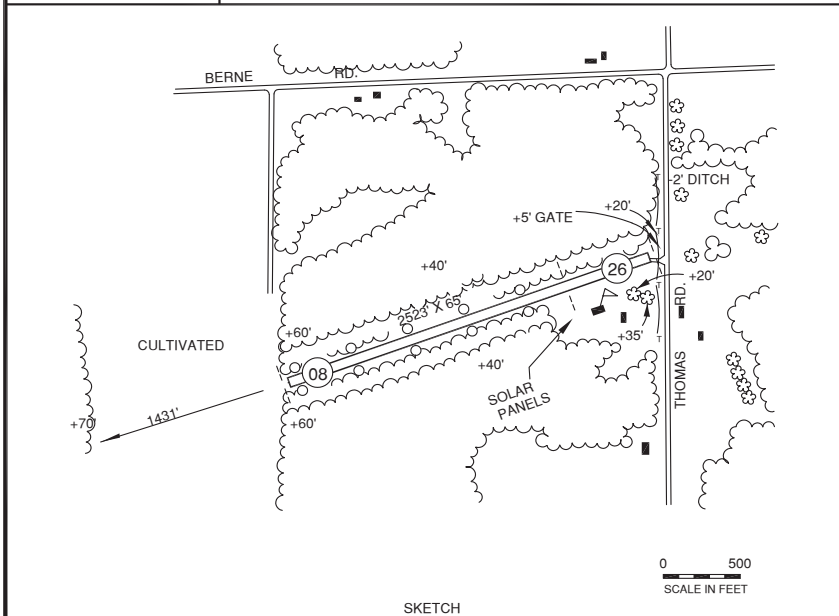
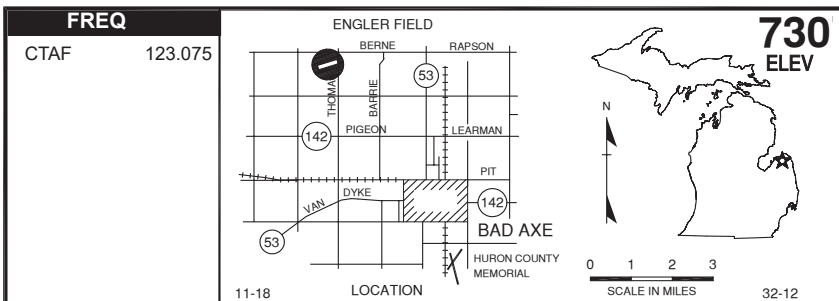

RWY LENGTH BEYOND DISPLACED THR

08/ —
26/ 1948

COORDINATES

43° 50.77' N
083° 02.81' W

License

Basic Utility

FM CITY: 4.0 mi NW

LGT: LIRL (NSTD*) not for public use

MGR: Alan Engler

PH: 989-269-8815

FBO: None

ATND: Intmt, owner resides at arpt

NAV AIDS: 112.9 (MBS) 075° 070° 48 NM to fld.

FUEL: None

RPR: None

WX: None

SNW RMVL: lreg-vfy

TRNSP: None

MEALS: In town, 4.0 mi

RON: In town, 4.0 mi

- Caution, 20' P-Lines in NE 26 apch.
- Crops W of rwy 08/26 can grow to 7 ft during growing season.
- * Rwy 26 NSTD LIRL. first 575' (dsplcd thld) not lighted.
- +5' gate 40 ft east of rwy.
- Wind turbine farm west of airport.