

DRUMMOND ISLAND (DRM)

D

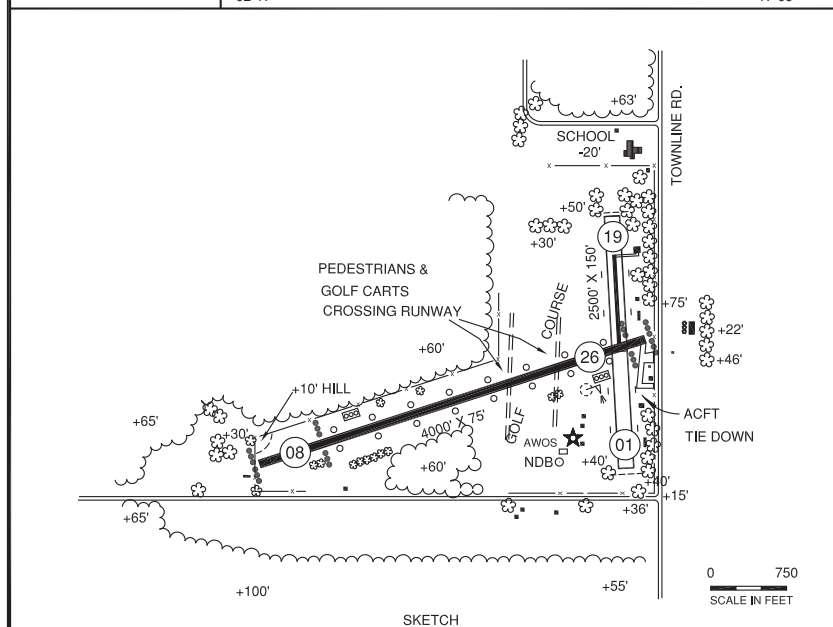
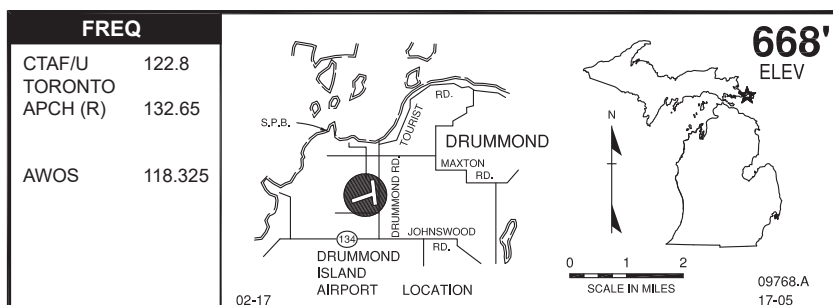

RUNWAY LENGTH BEYOND DISPLACED THR
08/ 3350' * 1/ —
26/ 3830' * 19/ —

COORDINATES
46° 00.56'N
083° 44.64'W

License
General Utility

FM CITY: 0.5 mi S
LGT: ROTG BCN. MIRL, PAPI— key mike 5X CTAF.
MGR: James Bailey
PH: 906-493-5411
906-493-5339 (Mgr Res)
FBO: Bailey Svcs 906-493-5411
ATND: Mon-Sat 0800-1700

NAV AIDS: IAP, 112.2 (SSM) 139° 33.9 NM to fld,
FUEL: MOGAS, 100LL, JET A-55MB
RPR: Major
WX: NWS SSM, SAWRS, AWOS 906-493-6410, internet access
SNW RMVL: Rwy 08/26
TRNSP: Rntl car
MEALS: In town
RON: In town, CC

- Rwy 01/19 center 20' portion of rwy from intersection Rwy 08/26 N to hangar line is asph.
- Customs avbl (ADCUS)— for details see Customs info. Prior notice call 906-632-8822, 906-632-7221.
- Birds on & invof arpt.
- Golf course adj to rwys with golf carts & pedestrians crossing.
- Camping / cooking permitted.
- Drummond Isl Yacht Haven S.P.B. 1.5 mi N.