

HOLLAND, PARK TOWNSHIP (HLM)

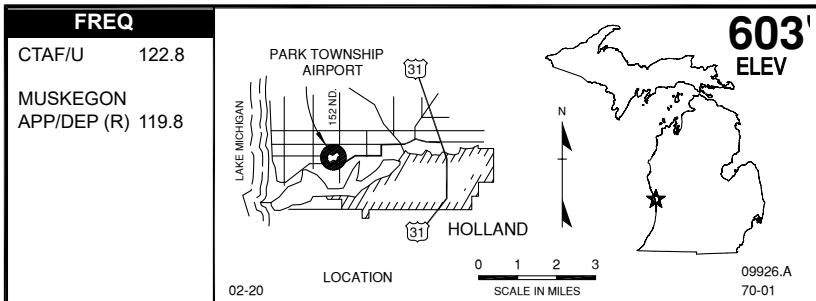

H

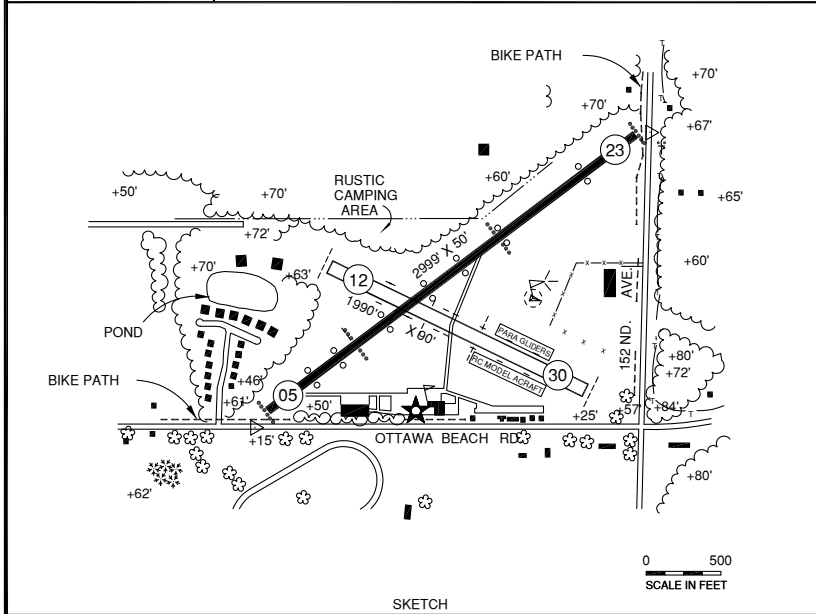

RWY LENGTH BEYOND DISPLACED THR

05/ 2291' * 12/ 1200'
23/ 1846' * 30/ 1100'

COORDINATES

42° 47.75'N
086° 09.72'W

License

Basic Utility

FM CITY: 3.0 mi NW
LGT: ROTG BCN. MIRL* Rwy 05/23 DUSK-2300 aftr 2300 CTAF.
MGR: James Munslow
PH: 616-399-9333 (Unatnd)
 616-304-7422 (Cell)
FBO: None
ATND: Unatnd

NAV AIDS: 112.1 (PMM) 353° 20.0 NM to fld,
FUEL: 100LL, mogas
RPR: None
WX: None
SNW RMVL: Rwy 05/23 only
TRNSP: Taxi, bikes avbl, CC
MEALS: 0.25 mi
RON: 7.0 mi, in town

- Rwy 12/30 CLSD Nov-Apr15 & when snow covered.
- 2020 check NOTAMS for possible construction and/or closures.
- * MIRL lctd nstd 24' FM rwy edge.
- Noise abatement procedures: No DEP turns before reaching 1200' MSL.
- Admin bldg access—depress 5-3-2-1.
- Rustic camping call avbl.
- Deer & birds on & invof arpt.