

LINCOLN, MILWRICK FLYING "M" (3L7)

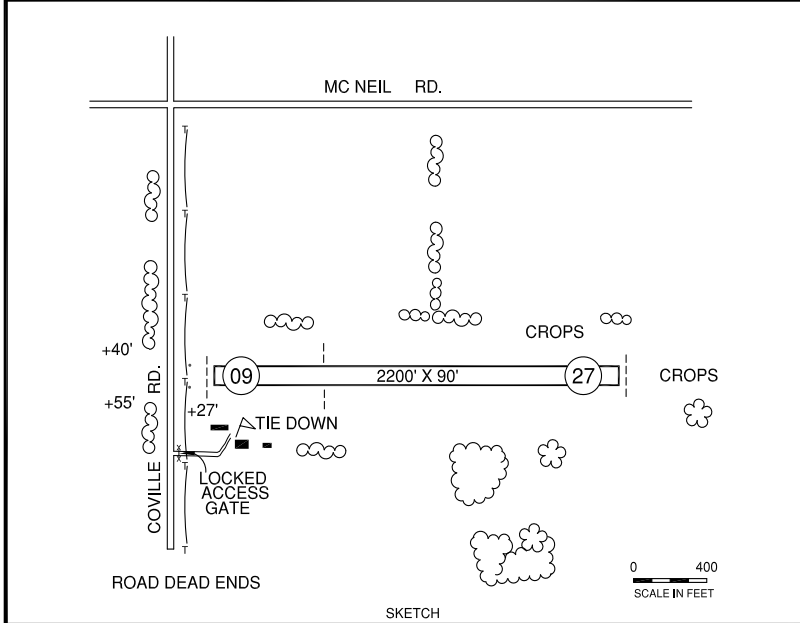
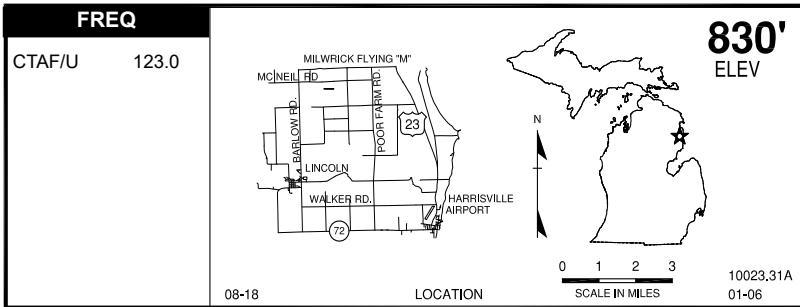

L

RWY LENGTH BEYOND DISPLACED THR

09/ 1600'

27/ —

COORDINATES

44° 44.30'N

083° 22.78'W

License:

Basic Utility

FM CITY: 3.0 mi N

LGT: None

MGR: Nancy Milwrick

PH: 989-736-1098

FBO: None

ATND: Ireg May - Oct (Owner resides at arpt)
Clsd Nov - Apr and when snw coverd.

NAV AIDS: 116.9 (ASP) 010° 18.0 NM to fld.

FUEL: None

RPR: None

WX: None

SNW RMVL: No

TRNSP: By prior angmt

MEALS: 5.0 mi

RON: In town, 5.0 mi

- Rwy 09 apch +32' pline mkd with yellow spheres.
- Rwy soft in spring.
- Rwy slopes down from west to east, ireg terrain.
- Arpt access gate locked. call mgr for access.
- Deer on and invof rwy.