

# NEWBERRY, LUCE COUNTY (ERY)

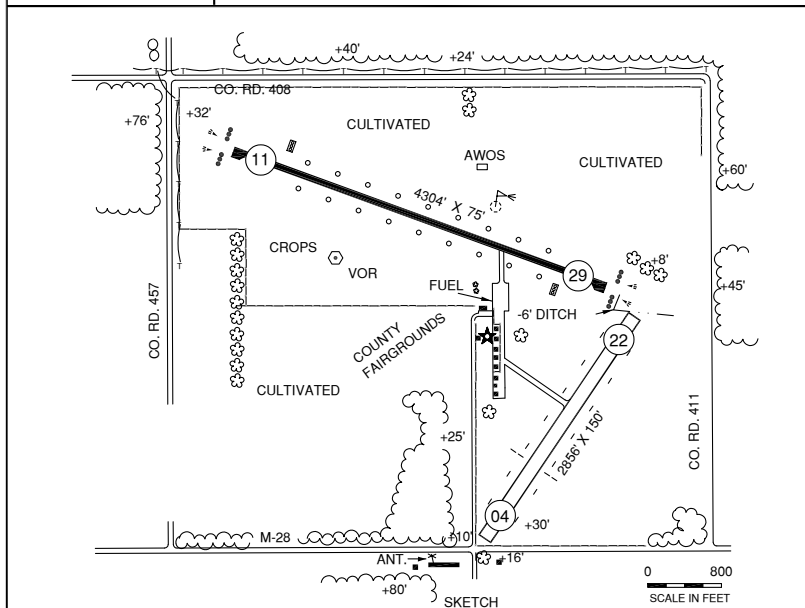
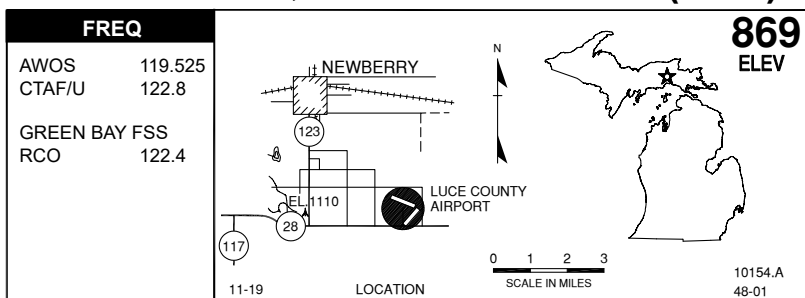

### RWY LENGTH BEYOND DISPLACED THR

11/ — \* 04/ 1920'  
 29/ — \* 22/ —

### COORDINATES

46° 18.66'N  
 085° 27.43'W

### License

General Utility

**FM CITY:** 3.0 mi SE

**LGT:** ROTG BCN SS-SR. MIRL, PAPI rwy 11/29, REIL rwy 11/29, wind cone & apron lgt—key mike 5X CTAF; 7X REILS.

**MGR:** Jay Hollnagel  
 Kenneth G. Gill, Asst

**PH:** 906-293-2926  
 906-291-0570 (Mgr cell)

**FBO:** None

**ATND:** Mon-Fri 0800-1600, Sat, Sun on req

**NAV AIDS:** IAP, 112.2 (SSM) 267° 48 NM to fld

**FUEL:** 100LL\* 24 hr Self Serve, Jet A

**RPR:** None

**WX:** AWOS 906-293-2979,

WX Briefing system

**SNW RMVL:** Rwy 11/29, vfy cond

**TRNSP:** Rntl car (in town) on req

**MEALS:** 0.4 mi , in town 4.5 mi

**RON:** In town, 1.0 mi

- Admin bldg access—5,3,2,1.
- Rwy 4/22 clsd Nov-Mar & when snw covered, except for ski equipped acft.
- Transient hgr avbl.