

PORT AUSTIN, GRINDSTONE (29C)

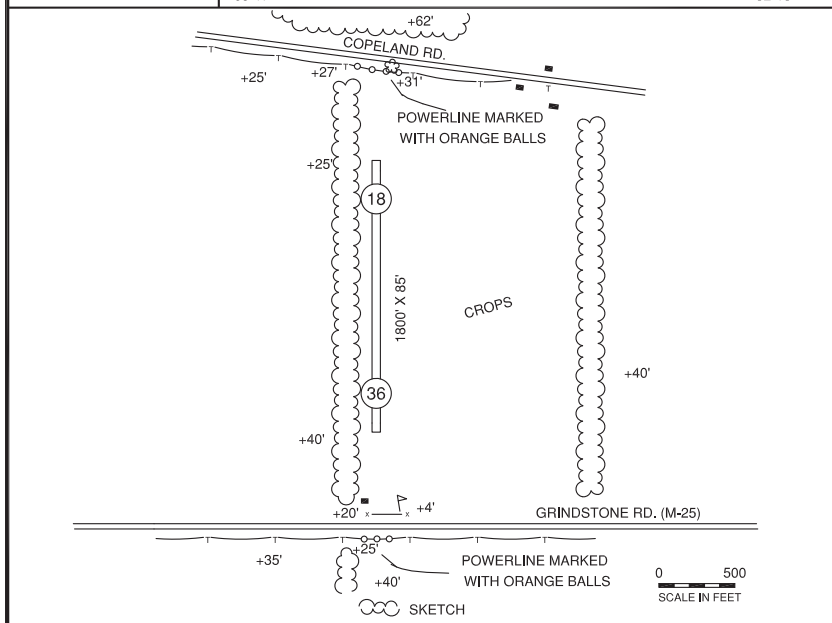
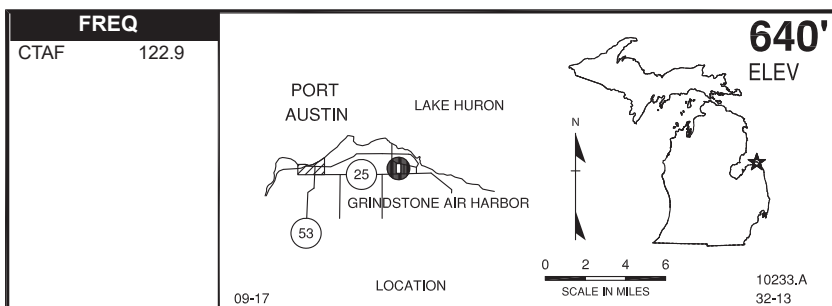

RUNWAY LENGTH BEYOND DISPLACED THR
 18/ —
 36/ —

COORDINATES
 44° 02.86'N
 082° 54.86'W

License Class
 Basic Utility

FM CITY: 4.0 mi E
LG: None
MGR: Kelly J. Hanson
PH: 989-269-9910
 989-269-7299
FBO: None
ATND: Unatnd

NAV AIDS: 112.9 (MBS) 061° 59 NM to fld.
FUEL: None
RPR: None
WX: None
SNW RMVL: No
TRNSP: None
MEALS: In town, 1.5 mi
RON: In town, 4.0 mi

- Rwy soft in spring.
- 25' p-line 720' S of rwy.
- 27' p-line 570' N of rwy.