

SAINT HELEN (6Y6)

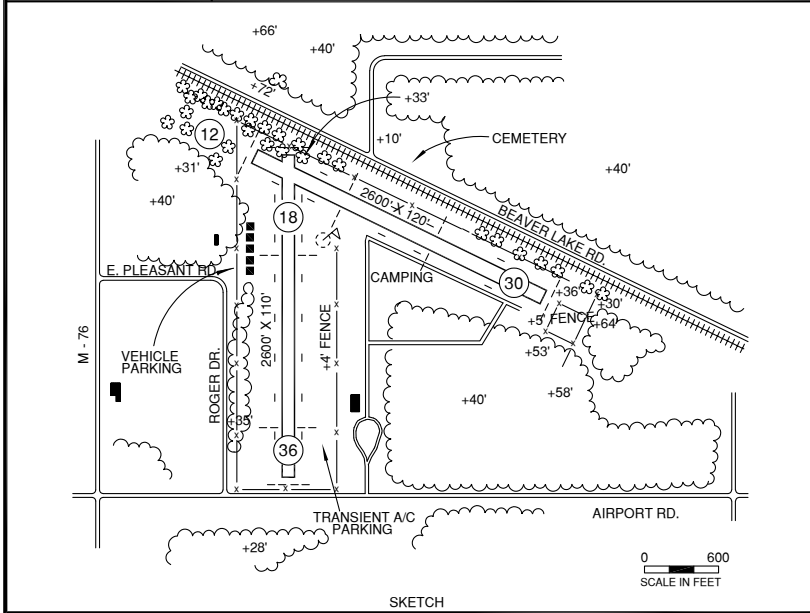
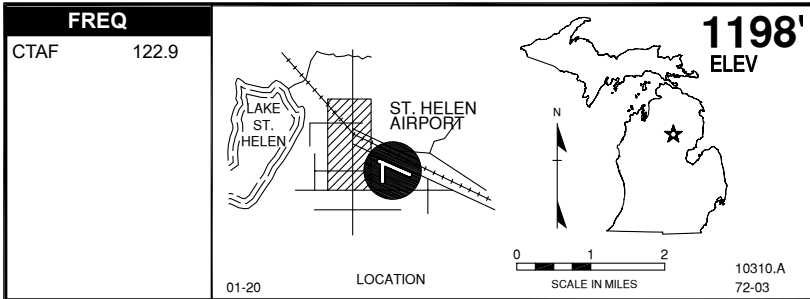

S

RWY LENGTH BEYOND DISPLACED THR

12/ 1788 * 18/ 1790
30/ 1612 * 36/ 2200

COORDINATES

44° 22.08'N
084° 24.13'W

License

Basic Utility

FM CITY: 1 mi SE

LG: None

MGR: James Hill

Tim Steinhauer, Asst

PH: 989-387-7412 (Mgr Cell)

989-389-4994 (Asst)

FBO: None

ATND: Unatnd*

NAV AIDS: 126.2 (GOV) 149° 23 NM to fld.

FUEL: None

RPR: None

WX: None

SNW RMVL: No

TRNSP: "Rosco" Roscommon Co Bus

MEALS: In town, 1 mi

RON: In town, 1 mi

- Richfield Twp Ofc (arpt owner) 989-389-4994.
- *Arpt CLSD Dec-Mar & when snow covered.