

SANDUSKY, COWLEY FIELD (96G)

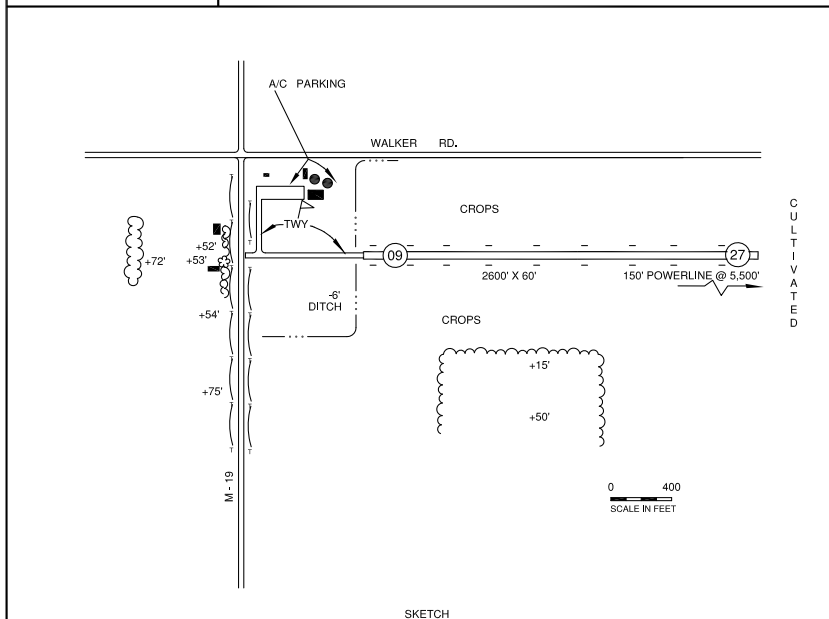
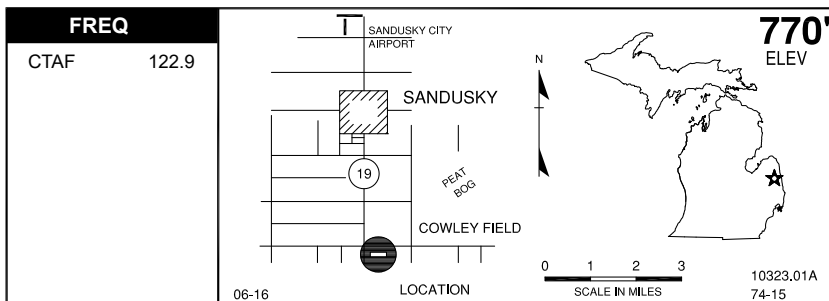

S

RWY LENGTH BEYOND DISPLACED THR

09/ —
27/ —

FM CITY: 3.0 mi S

LGT: None

MGR: Dale Cowley
Scott Cowley, Asst

PH: 810-837-0111
810-837-3226

FBO: None

ATND: Ireg (Mgr resides at arpt)

COORDINATES

43° 22.54N
082° 49.13'W

License

Basic Utility

NAV AIDS: 112.2 (MBS) 102° 56 NM to fld

FUEL: None

RPR: None

WX: None

SNW RMVL: Ireg-vfy cond

TRNSP: None

MEALS: 3.0 mi

RON: None

- Ditch 25' wide x 6' deep, 745' from W end of rwy.
- Deer & turkeys invof arpt.
- Pwr poles in close proximity to taxiway at W end.