

# WAYLAND, CALKINS FIELD (41C)

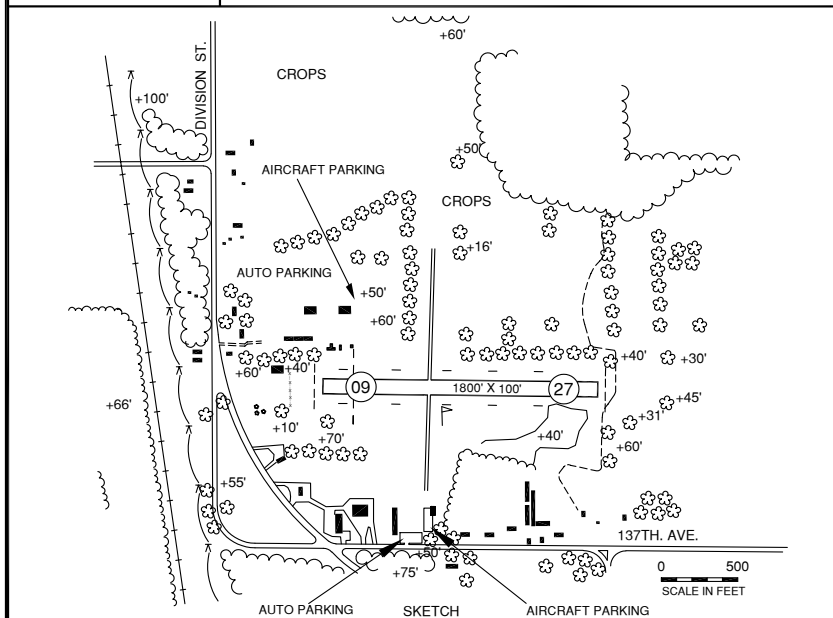
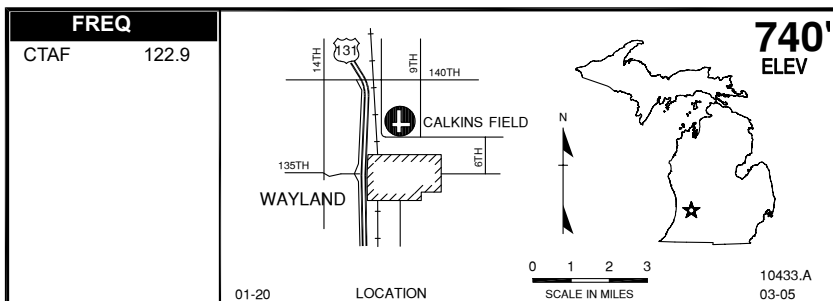

## RWY LENGTH BEYOND DISPLACED THR

09/ 1600'  
27/ —

## COORDINATES

42° 41.50'N  
085° 38.75'W

## License

Basic Utility

**FM CITY:** 1.0 mi N

**LGT:** None

**MGR:** Pete Steinbacher

**PH:** 616-889-5971 (Mgr cell)

**FBO:** None

**ATND:** Unatnd

**NAV AIDS:** 115.95 (GRR) 234° 8.7 NM to fld

**FUEL:** None

**RPR:** None

**WX:** None

**SNW RMVL:** No-vfy cond

**TRNSP:** None

**MEALS:** 1.0 mi

**RON:** 1.5 mi

W

- Rwy soft when wet.
- Ultralight actvty.
- Rwy 01/19 local use only.
- Additional contact Clarence Slaughter 616-813-8903.