

# How to Use Your BRITA® Faucet Filter Certified to Reduce Lead in Drinking Water

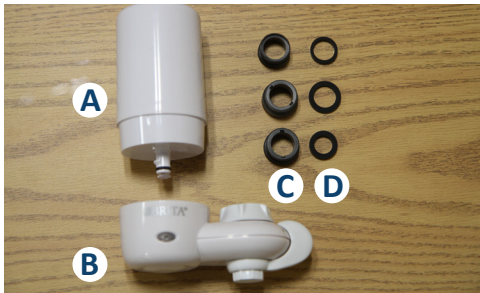

A certified filter can be used as a temporary way to reduce lead in drinking water. Filters are made to reduce lead, but do not guarantee that all lead will be removed from your drinking water. It is important to follow manufacturer's directions.

If you're buying a filter, read the packaging to be sure it says the filter is certified to NSF/ANSI Standard 53 for lead reduction. The U.S. Environmental Protection Agency also recommends that the filter be certified for NSF/ANSI Standard 42 for particulate reduction (Class I).



## What's in the box

- A Filter cartridge
- B Filter base
- C Adapters (you may or may not need one of these)
- D Rubber washers (these match up with the adapters)

## Adapter installation

Most sink faucets have an aerator at the end that can be removed. Unscrew and remove it. If your faucet has threads on the OUTSIDE, you will not need an adapter or rubber washer. If your faucet has threads on the INSIDE, you will need to use one of the adapters.

Try out the different adapters (C) to find the one that best fits your faucet. Once you find the best fit, put the rubber washer (D) on the adapter and screw the adapter onto your faucet.



## Filter installation

### Step 1

Place the filter base (B) under your faucet with the cartridge cup to the left of your faucet. Twist the mounting collar onto the faucet and tighten by hand. Do not over tighten or use pliers.



### Step 2

Place your hand under the filter base cartridge cup. With the filter cartridge (A), align the pegs on the bottom of the cartridge with the holes in the cartridge cup and push down until you hear a click.



## Using your filter

There is a white filter handle on the right side of the filter base. Move the handle towards the Brita logo (front of the base) to use the filter. Only run COLD water through the filter at all times.

When you use your filter for the first time ONLY, run cold water for five minutes. Prior to each use, run cold water for five seconds to activate the filter. If the filter has not been used for a few days, let the water run for thirty seconds before use.





## Filter settings on the filter base

**Filtered Water** – Brita water drop symbol in front of the filter base handle

**Not Filtered Water Stream** – Single water drop symbol in the middle of the filter base handle

**Not Filtered Water Spray** – Three water drops symbol behind the filter base handle

## When should you use filtered or not filtered water?

### Cold Filtered Water

Drinking  
Cooking  
Making baby formula  
Rinsing fruits and vegetables  
Brushing kids' teeth  
Pets' water bowls\*

### Not Filtered Water

Washing your hands  
Washing dishes, clothes  
Cleaning floors, countertops  
Showering or bathing. Adults and children should avoid swallowing the water  
Brushing adults' teeth

\*Per Michigan Department of Agriculture and Rural Development

## Changing your filter

Each time you use your filter, a light will flash on the front six times.

**Green** - Your filter is working

**Green and Red** - Your filter is working, but you will need to change it soon.

**Red** - It is time to change your filter. Press the filter cartridge release button at the back of the filter cup and pull the cartridge up. Revisit step 2 of filter installation to place a new cartridge in the filter cup.

## Removing your filter

Should you need to remove your filter unit, simply unscrew the filter mounting collar from the faucet.



Contact the manufacturer if you have questions about your filter. For information about lead exposure and your health, call the Michigan Department of Health and Human Services Drinking Water Hotline at 844-934-1315 or visit [Michigan.gov/MiLeadSafe](http://Michigan.gov/MiLeadSafe).

The Michigan Department of Health and Human Services (MDHHS) does not discriminate against any individual or group because of race, religion, age, national origin, color, height, weight, marital status, genetic information, sex, sexual orientation, gender identity or expression, political beliefs or disability.

February 2020 Version 2

