

Mr. David Atchison  
108 West Erie St.  
Albion, MI. 49224

15 November 2021

Michigan Department of State  
Bureau of Elections  
Richard H. Austin Building – 1<sup>st</sup> Floor  
430 West Allegan Street  
Lansing, Michigan 48918

RECEIVED/FILED  
MICHIGAN DEPT OF STATE  
2021 NOV 23 AM 9:05  
ELECTIONS/GREAT SEA

Campaign Finance Complaint ICO: Ginger Obermeyer

Name & phone number of persons filing the complaint: **David H. Atchison / Ph (301) 655-8354**

Address of person filing complaint: **108 West Erie St, Albion, MI. 49224**

The alleged violator's name: **Ginger Obermeyer** (*Kids First Campaign* Treasurer)

The Alleged violator's address: **215 East Drive  
Marshall, MI 49068**

## **Allegations:**

### **Section(s) of the MCFA Violated:**

- Section 26 (1) (b) & (1) (j)
- Section 33 (1), (10) & (11)
- Section 34 (7)

*Kids First* Campaign Treasurer Ginger Obermeyer, knowingly filed an incomplete and inaccurate Pre-Election Campaign finance report as detailed below.

1. Section 26 (1) (b) of the MCFA was violated as follows: The Committee's actual business address was not entered into Block 6. Ginger Obermeyer is employed by the Calhoun County Intermediate School System. Block 6 shows Ginger Obermeyer's residential address NOT her business address. The address shown in Block 5 and Block 6 are both her residential address.
2. Section 26 (1) (j); 33 (1); 33 (10); (11); and 34 (7) of the MCFA were violated as follows: Campaign Committee Treasurer Ginger Obermeyer filed an incomplete and inaccurate Pre-Election Campaign Report by omitting the full name and street address of each person or business entity to whom expenditures were made failed to report the amounts and purposes of numerous expenditures made, or in-kind contributions received during the period 8/26/21 to 10/17/21. Ginger Obermeyer demonstrated an understanding of her responsibility, as Committee Treasurer to report expenditures on the Committee's Pre-Election report as evidenced by her inclusion of the \$84.08 in fees expended for online fees to Stripe INC. However, Giner Obermeyer omitted more than ten (10) individual expenditures required to be disclosed by the MCFA, and as a result of knowing the mandated reporting requirements outlined in MCFA, Ginger Obermeyer knowingly filed an incomplete and inaccurate report in violation of the MCFA.

Mr. David Atchison  
108 West Erie St.  
Albion, MI. 49224

3. Section 26 (1) (e) of the MCFA was violated as follows: Schedule 4A, Page 2 of 12 for the Pre-election report has an inaccurate name in Block 3 for Contribution #4. The correct name is: Ian Gilyard-Schnaitman. The name entered by Ms. Obermeyer is Ian Schnaitman
4. Section 26 (1) (e) of the MCFA was violated as follows: Schedule 4A, Page 3 of 12 for the Pre-election report has an incorrect name in Block 3 for Contribution #3. The correct name is: Mae Olla Dunklin. The name entered by Ms. Obermeyer is Mae Olla. **(Refer to extract from Registered Voter Roll for City of Albion – provided as substantiating evidence.)**
5. Sections 26 (1)(e), (1)(g) & 33 (10) of the MCFA were violated as follows: Schedule 4A, Page 12 of 12 for the Pre-election report has a false name in Block 3 for Contribution #1. *Kingscott Associates*, is a business contracted by MPS in support of developing and getting the bond passed as a local ballot question. Mr. Robert Atkins (3<sup>rd</sup>) is the President of *Kingscott Associates*, located at 259 E Michigan Ave #308, Kalamazoo, MI 49007. Ginger Obermeyer knowingly filed an inaccurate report by entering a name of someone other than the actual contributor. The address entered into Block #1 is the business address for *Kingscott Associates*. It is unknown whether the \$500.00 was actually donated by the president of the company or some other Kingscott employee. **(Refer to extract from *LinkedIn* – provided as supporting evidence.)**
6. Sections 26 (1)(b), (j); 33 (1), (10), (11); & 34 (7) of the MCFA were violated as follows: *Kids First* Campaign Treasurer Ginger Obermeyer, knowingly filed an incomplete – inaccurate Pre-Election Campaign Finance Report by failing to report in-kind contributions or expenditures of committee funds during the period of the report for the professional production services of the *Kids First Committee* campaign logo by *BlueFish Consulting, LLC* located at 115 W Michigan Ave, Marshall, MI 49068. (A copy of a screenshot from 2 Sep 2021 -during the period of the report - showing the logo, is provided as substantiating documentation.)
7. Sections 26 (1)(b), (j); 33 (1), (10), (11); & 34 (7) of the MCFA were violated as follows: *Kids First* Campaign Treasurer Ginger Obermeyer, knowingly filed an incomplete – inaccurate Pre-Election Campaign Finance Report by failing to report in-kind contributions or expenditures of committee funds during the period of the report for the professional graphic production services of the *Kids First Committee* campaign digital ads WHERE? Created on or before 21 September 2021 -during the period of the report. (A copy of a screenshot from 21 Sep 2021 showing the add is provided as substantiating documentation.)
8. Sections 26 (1)(b), (j); 33 (1), (10), (11); & 34 (7) of the MCFA were violated as follows: *Kids First* Campaign Treasurer Ginger Obermeyer, knowingly filed an incomplete – inaccurate Pre-Election Campaign Finance Report by failing to report in-kind contributions or expenditures of committee funds during the period of the report for the professional graphic production services of the *Kids First Committee* campaign digital

Mr. David Atchison  
108 West Erie St.  
Albion, MI. 49224

add WHERE? Created on or before 21 September 2021 -during the period of the report. (A copy of a screenshot from 21 Sep 2021 showing the add is provided as substantiating documentation.)

9. Sections 26 (1)(b), (j); 33 (1), (10), (11); & 34 (7) of the MCFA were violated as follows: *Kids First* Campaign Treasurer Ginger Obermeyer, knowingly filed an incomplete – inaccurate Pre-Election Campaign Finance Report by failing to report in-kind contributions or expenditures of committee funds during the period of the report for the professional graphic services to produce the campaign video “MARSHALL PUBLIC SCHOOLS 2021 BOND” for the *Kids First Committee* campaign. Created on or before 22 September 2021 -during the period of the report. (A copy of a screenshot from 22 Sep 2021 showing the video is provided as substantiating documentation.)
10. Sections 26 (1)(b), (j); 33 (1), (10), (11); & 34 (7) of the MCFA were violated as follows: *Kids First* Campaign Treasurer Ginger Obermeyer, knowingly filed an incomplete – inaccurate Pre-Election Campaign Finance Report by failing to report in-kind contributions or expenditures of committee funds during the period of the report for the purchase of *Kids First Committee* campaign yard signs and “H” sign brackets during the Pre-Election reporting period. **\*Substantiating evidence provided includes:** copy of a screenshot from 2 Oct 2021, taken from campaign committee FB page showing a sign and advertising the signs are available; screenshot taken of MPS School Board member Matt Davis’ personal FB page offering -*Kids First Committee* VOTE YES campaign signs to **Campaign Committee Treasurer Ginger Obermeyer**, District Superintendent Becky Lynn Jones, School Board President Richard Lindsey and the remaining members of the MPS School Board (Shawana Gamble, Larry Williams & Amanda Lanker); witness statement from Michele Johnson stating she took the screen shot of Matt Davis’ FB page showing/ offering VOTE YES campaign signs 1 October 2021. It is not plausible to believe Committee Treasurer Ginger Obermeyer was unaware committee funds were expended by the committee, or in-kind contribution in the form of campaign signs were received during the period of the report with the more than 50 signs on displays in resident yards within MPS District.
11. Sections 26 (1)(b), (j); 33 (1), (10), (11); & 34 (7) of the MCFA were violated as follows: *Kids First* Campaign Treasurer Ginger Obermeyer, knowingly filed an incomplete – inaccurate Pre-Election Campaign Finance Report by failing to report in-kind contributions or expenditures of committee funds during the period of the report for the professional graphic services to produce the *Kids First Committee* campaign digital ads WHERE? Created on or before 21 September 2021 -during the period of the report. (A copy of a screenshot from 21 Sep 2021 showing the add is provided as substantiating documentation.)
12. Sections 26 (1)(b), (j); 33 (1), (10), (11); & 34 (7) of the MCFA were violated as follows: *Kids First* Campaign Treasurer Ginger Obermeyer, knowingly filed an incomplete – inaccurate Pre-Election Campaign Finance Report by failing to report in-kind contributions or expenditures of committee funds during the period of the report for the

Mr. David Atchison  
108 West Erie St.  
Albion, MI. 49224

professional graphic services which produced a series of four (4) social media adds featuring quotes and photo cameos of supporters for the school bond posted 5 October 2 (Carol Stewart), 6 October 202 (Matt & Danielle Seibert), 17 October 2021 (Tara & Ryan) and 17 October 2021 (Steve & Kathy Searles. (Copies of screen shots of each of the 4 adds are provided as substantiating evidence.)

13. Sections 26 (1)(b), (j); 33 (1), (10), (11); & 34 (7) of the MCFA were violated as follows:  
*Kids First* Campaign Treasurer Ginger Obermeyer, knowingly filed an incomplete – inaccurate Pre-Election Campaign Finance Report by failing to report in-kind contributions or expenditures of committee funds during the period of the report for the professional graphic services to produce of the *Kids First Committee* campaign digital ads WHERE? Created on or before 21 September 2021 -during the period of the report. (A copy of a screenshot from 21 Sep 2021 showing the add is provided as substantiating documentation.)
14. Sections 26 (1)(b), (j); 33 (1), (10), (11); & 34 (7) of the MCFA were violated as follows:  
*Kids First* Campaign Treasurer Ginger Obermeyer, knowingly filed an incomplete – inaccurate Pre-Election Campaign Finance Report by failing to report in-kind contributions or expenditures of committee funds during the period of the report for the for two (2) political campaign adds published in local newspapers during the period of the report. Copies of the newspaper adds are provided as substantive evidence.
  - a. Published 7 October 2021 in *The Recorder*, (Albion, MI.)
  - b. Published 9 October 2021 in e *Ad-Visor & Chronicle* )Marshall, MI.)
15. Sections 26 (1)(b), (j); 33 (1), (10), (11); & 34 (7) of the MCFA were violated as follows:  
*Kids First* Campaign Treasurer Ginger Obermeyer, knowingly filed an incomplete – inaccurate Pre-Election Campaign Finance Report by failing to report in-kind contributions or expenditures of committee funds during the period of the report for the professional production and printing of large quantities of 7” X 9” color, glossy, double-sided campaign cards. Copies of screen shots of multiple cards and an actual campaign card are provided as substantive evidence.
16. Sections 26 (1)(b), (j); 33 (1), (10), (11); & 34 (7) of the MCFA were violated as follows:  
*Kids First* Campaign Treasurer Ginger Obermeyer, knowingly filed an incomplete – inaccurate Pre-Election Campaign Finance Report by failing to report in-kind contributions or expenditures of committee funds during the period of the report for the legal services provided by law firm representing the *Kids First Committee*. A copy of the 28 September 2021 letter issued by law firm is provided as substantive evidence.

Mr. David Atchison  
108 West Erie St.  
Albion, MI. 49224

17. Sections 26 (1)(b), (j); 33 (1), (10), (11); & 34 (7) of the MCFA were violated as follows:  
*Kids First* Campaign Treasurer Ginger Obermeyer, knowingly filed an incomplete – inaccurate Pre-Election Campaign Finance Report by failing to report in-kind contributions or expenditures of committee funds during the period of the report for the first-class postage & direct campaign mail sent in September 2021 on behalf of the *Kids First Committee*. A copy of the campaign mailer is provided as substantive evidence.

**Section 4. Certification (Required)**

*I certify that to the best of my knowledge, information, and belief, formed after a reasonable inquiry under the circumstances, each factual contention of this complaint is supported by evidence.*

X

  
Signature of Complainant

15 Nov 2021  
Date

	A	B	C	D	E	G	H	I	J	K	L	M	N	O
1			Extract from Registered Voter Roll -											
	JURISD		LAST	FIRSTN	MIDDLE				RES	STREET	STREE		POST	
2	NAME	PRECINCT	NAME	AME	NAME	YOB	REGDATE	GENDER	NUM	STREETNAME	TTYPE	POCITY	ATE	ZIPCODE
3	ALBION													
	CITY	5	DUNKLIN	MAE	OLA	1948	7/16/1996 F		707	HUNTINGTON	BLVD	ALBION	MI	49224





Home



My Network



Jobs

[Get a \\$650 Prepaid Card. - Switch to Comcast Business for our Best Deal of the](#)



**Robert Atkins** · 3rd

President at Kingscott Associates

-  Kingscott Associates
-  Michigan Technological University

Kalamazoo, Michigan, United States · [Contact info](#)

500+ connections

Connect

 Message

More

## About

Have been in the professional consulting business since 1992 working in the following areas/markets:

[... see more](#)

## Activity

863 followers

Posts Robert created, shared, or commented on in the last 90 days are displayed here.

[See all activity](#)



# Schaeffer Law Offices

**J. Thomas Schaeffer, Attorney at Law**

**Aaron A. Bartell, Attorney at Law**

206 S. Kalamazoo Avenue - Marshall, Michigan 49068-1582

Telephone: (269) 781-5193 - Fax: (269) 781-2157

Email: [schaefferlawoffices@gmail.com](mailto:schaefferlawoffices@gmail.com)

[www.SchaefferLawOffices.com](http://www.SchaefferLawOffices.com)

September 28, 2021

Erica Robinson  
17354 20-1/2 Mile Road  
Marshall, MI 49068

Kristin Burkwalt  
27709 D Drive North  
Albion, MI 49224

Dear Ms. Robinson and Ms. Burkwalt:

Please be advised that this office represents Kids First Campaign Committee concerning certain postings on the internet that are inaccurate and defamatory. Reference has been made on Monday, September 20, 2021 and Tuesday, September 21, 2021 to a return address on an envelope belonging to someone who is in prison and previously lived at said address pursuant to the allegations on the internet. These allegations are false, and they are defamatory to the point that they give improper connotations in light of the discussions thereafter. This letter is sent with a demand that you cease and desist making such allegations concerning this address.

If in fact the postings concerning these false allegations continue, then appropriate legal action will be taken to deal with damages that are being inflicted upon the Kids First Campaign Committee. Further, discussion of these falsities by the publication of this letter or any other letter will be taken as exacerbation of the damages that you have already inflicted.

If you have questions concerning this, please advise.

Thank you.

Yours truly,

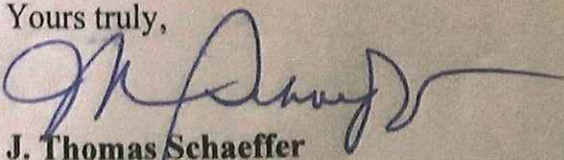

**J. Thomas Schaeffer**  
**Schaeffer Law Offices**

JTS/slh



8:49

35%



Kids First Campaign - Ma...



Home

**Posts**

Reviews

Videos

Photos



**Kids First Campaign - Marshall Public School District** updated their profile picture.

Sep 2 •



Save

...

10:06

91%

← Kids First Campaign - Ma...

[Home](#) [Posts](#) [Reviews](#) [Videos](#) [Photos](#)**Kids First Campaign - Marshall  
Public School District**

Sep 21 •

What is involved with selecting a location for a new school? A lot. Take a look at this graphic for a list of some of the... [See More](#)

**Where?**  
One word with a lot of weight.

How do districts select the site for a school?  
*The process is not as easy as it may seem.*

Many costly factors must be considered including:

- Zoning laws
- Relation to present/future developments
- Soil Composition
- Historical land markers
- State laws on minimum site size
- Stakeholder input
- Accessibility / ADA compatibility
- Maximum walking distance laws
- Elevation (flooding, etc.)
- Off-site interference
- Accessibility to public safety
- Atmospheric conditions (smoke, dirt)
- Accessibility to highway
- Traffic flow
- Acquisition / Development Costs
- Historical land use analysis

  
votekidsfirst.com

[Save](#)

...

10:05

92%



Kids First Campaign - Ma...



Home

Posts

Reviews

Videos

Photos

**Kids First Campaign - Marshall  
Public School District**

Sep 22 •

A short video with details about the bond.  
Please feel free to ask questions.



30 89 Comments • 64 Shares • 3.2K Views



Share

Save



This post on social media occurred 10/1/2021 by an MPS Board Member (Matt Davis) and tagging other MPS Board members (Richard Lindsey, Shawna Gamble, Larry Williams, Amanda Lankerd) and District Staff (Becky Lynn Jones).



Matt Davis

Would any of my friends in the Marshall Public Schools district like a sign to show support for the upcoming millage? Please let me know. Thank you. Ginger Obermyer, Richard C. Lindsey Jr., Shawna Gamble, Larry Williams, Amanda Lankerd, Becky Lynn



At the conclusion of the MPS Bond Forum on Tuesday, October 5, 2021 at Marshall Opportunity High School, 225 East Watson Street, Albion Michigan, I witnessed MPS Board of Education Trustee Shawana Gable make an announcement to the crowd as everyone was leaving the auditorium, "If anyone wants a Kids First sign, I have some in my car."

Michele Johnson – Eckford Township, Michigan



10:05

92%



Kids First Campaign - Ma...

[Home](#)[Posts](#)[Reviews](#)[Videos](#)[Photos](#)**Kids First Campaign - Marshall  
Public School District**

Oct 2 • 🌐

Show your support with a yard sign. If you'd like one, please message us with your address. We'll deliver it to ... See More



Save



10:05

92%



Kids First Campaign - Ma...

[Home](#)[Posts](#)[Reviews](#)[Videos](#)[Photos](#)**Kids First Campaign - Marshall  
Public School District**

Oct 15 • 🌐

"I often recall what my former principal would say, 'For many children the best part of their day is when they're in s... See More

[Save](#)

10:05

92%



Q Kids First Campaign - Ma...

[Home](#)[Posts](#)[Reviews](#)[Videos](#)[Photos](#)**Kids First Campaign - Marshall  
Public School District**

Oct 16 •

"Education is more than content. It's a safe and comfortable learning space. It's resources for teachers and staf... See More



Save

...



10:05

92%



Kids First Campaign - Ma...

[Home](#)[Posts](#)[Reviews](#)[Videos](#)[Photos](#)**Kids First Campaign - Marshall  
Public School District**

Oct 17 • 🌐

"For our students and our kids. Vote yes  
for the future of MPS." - Tara & Ryan

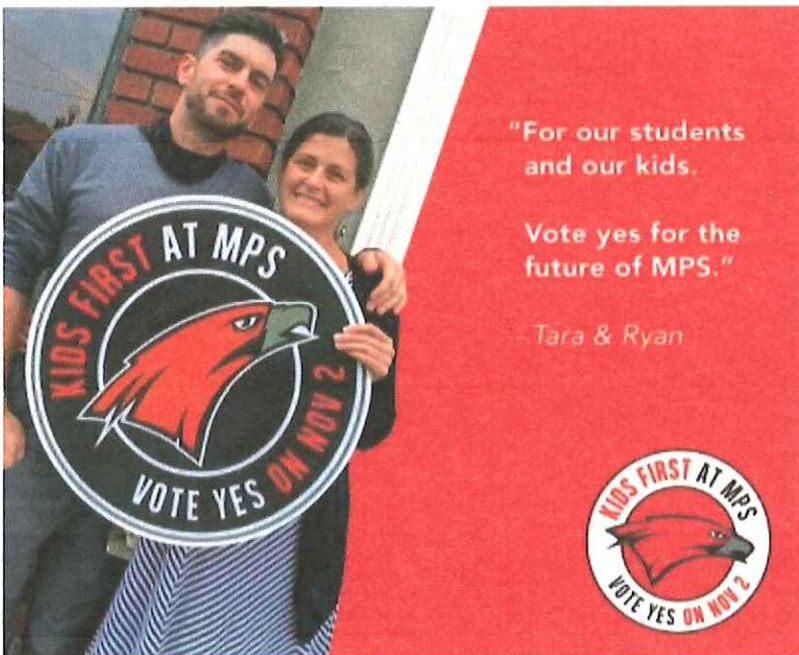

Save





10:05

92%



Kids First Campaign - Ma...



Home

Posts

Reviews

Videos

Photos

30

1 Comment • 5 Shares



Share

**Kids First Campaign - Marshall  
Public School District**

...

Oct 17 •

"We are voting yes for the future of  
Marshall Public Schools and its students!"  
- Steve and Kathy Searles

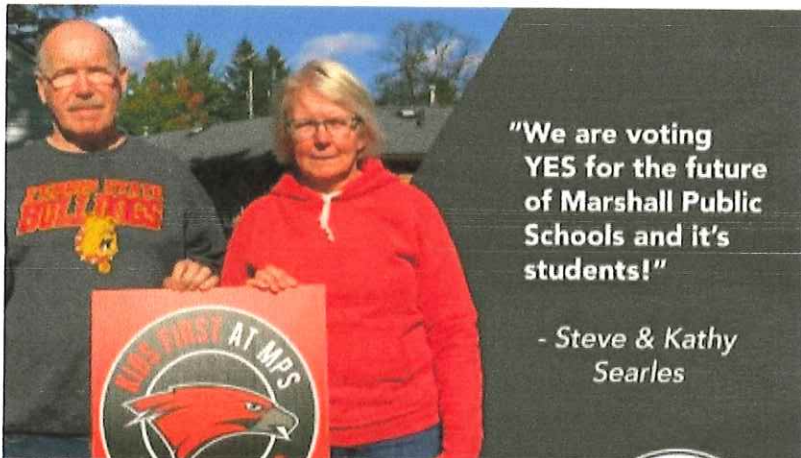

Save

...





# The Marshall Public Schools 2021 Bond includes an all-new K-5 elementary school in Albion.

We're proud of the youth in Albion. With enrollment at Harrington Elementary currently at capacity, this means that the Albion community is growing and full of potential. Passing the Marshall Public Schools 2021 Bond means that Albion children will have access to a state-of-the-art facility - the newest in the district.

**Features include:**

- 56,000 square feet
- Upper and lower elementary playground equipment
- Separate bus and student drop off zones
- General & special education classrooms
- Media center
- Art room
- Music room
- Gymnasium
- Cafeteria

**Passing the 2021 bond means:**

- \$16,920,000 will be put back into the Albion community in the form of a new school.
- Families of Albion will have access to a modern educational environment that's close to home.
- Albion taxpayers will experience a tax increase of 3.0 mills, whereas Marshall taxpayers will continue paying 7.05 mills.

**VOTE "YES" NOVEMBER 2, 2021 | [VoteKidsFirst.com](https://www.votekidsfirst.com)**



Rec'd via email 10/22/21  
8:47a jsl



MICHIGAN DEPARTMENT OF STATE  
BUREAU OF ELECTIONS

BALLOT QUESTION COMMITTEE  
COVER PAGE

FOR OFFICIAL USE ONLY

Report must be legible, typed or printed in ink and signed by the  
treasurer or designated record keeper.

3. This Statement covers From: 8/26/21 To 10/17/21 ✓

1. Committee I.D. Number

144097

4. Committee's Mailing Address

215 East Drive  
Marshall, MI 49068  
419-262-4429

Area Code and Phone: \_\_\_\_\_  
If the address in this box is different from the committee mailing address on  
the Statement of Organization, mail may be sent to this address by the filing  
official.

2. Committee Name

Kids First Campaign

5. Treasurer's Name and Residential Address

Ginger Obermyer  
215 East Dr Marshall, MI 49068  
419-262-4429

Area Code and Phone

6. Treasurer's Business Address

215 East Drive  
Marshall, MI 49068

Area Code and Phone

419-262-4429

7. Designated Record Keeper's Name and Mailing Address  
(If the committee has a Designated Record Keeper)

Derek Allen  
524 W Green St  
Marshall, MI 49068  
517-418-0001

Area Code and Phone

8. TYPE OF STATEMENT:

8a. ☒ PRE-ELECTION  
OR  
☐ POST-ELECTION

Pre-Election or Post-Election  
Statement relates to:

☐ PRIMARY  
☐ GENERAL  
☒ SCHOOL  
☐ SPECIAL  
☐ OTHER: \_\_\_\_\_

Date of Election:

11/2/21

8b.

☐ FEBRUARY STATEMENT  
☐ APRIL STATEMENT  
☐ JULY STATEMENT  
☐ OCTOBER STATEMENT

8c. ☐ ANNUAL STATEMENT  
(\_\_\_\_ Coverage Year)

8d.

☐ Post Petition Sample Filing  
under MCL 168.483a

(Required of Statewide Ballot  
Question Committees only after  
the submission of a sample petition  
prior to circulating the petition)

8e. ☐ AMENDMENT TO  
CAMPAIGN STATEMENT

(Complete Item 8a, 8b, 8c 8d, or 8f  
to indicate which Statement is  
being amended)

8f. ☐ DISSOLUTION OF  
COMMITTEE REQUEST

Effective Date of Dissolution

By checking this item, I certify that  
the committee has no assets or  
outstanding debts, including late  
filing fees. Note: The disposition of  
residual funds must be reported on  
Schedule 4B and the Summary  
Page.

A committee that does not have a Reporting Waiver must file all required Campaign Statements. The Campaign Statements must include all applicable Schedules. Direct contributions, in-kind contributions, loans, expenditures and outstanding debts count against the \$1,000 Reporting Waiver threshold. If any of the information listed in Items 4, 5, 6, or 7 has changed since the information was shown on the committee's Statement of Organization, an amendment to the Statement of Organization should accompany this Campaign Statement. If a request for a Reporting Waiver is not received on or before the filing deadline of a required campaign statement, that campaign statement can not be waived.

9. Verification: I certify that all reasonable diligence was used in the preparation of this statement and attached schedules (if any) and to the best of my knowledge and belief the contents are true, accurate and complete.

Current Treasurer or  
Designated Record Keeper

Type or Print Name

Ginger Obermyer

Signature

[Signature]





MICHIGAN DEPARTMENT OF STATE  
BUREAU OF ELECTIONS

**SUMMARY PAGE  
BALLOT QUESTION COMMITTEE**

1. Committee I.D. Number

144097

2. Committee Name

Kids First Campaign

**RECEIPTS**

3. Contributions

a. Itemized Contributions (Schedule 4A, Column 6)

(3a.) \$ 5630.00 ✓

b. Unitemized Contributions  
(less than \$20.01 - no Schedule)

(3b.) \$ NOT APPLICABLE

c. Subtotal of Contributions

\* (3c.) \$

4. Other Receipts (Schedule 4A-1, Column 6)

(4.) \$

5. TOTAL CONTRIBUTIONS AND OTHER RECEIPTS  
(Add Line 3 c + Line 4)

(5.) \$ 5630.00 ✓

**IN-KIND CONTRIBUTIONS**

6. In-Kind Contributions

a. Itemized In-Kind Contributions  
(Schedule 4-1K, Column 7)

(6a.) \$

b. Unitemized (less than \$20.01 each - no Schedule)

(6b.) \$ NOT APPLICABLE

7. TOTAL IN-KIND CONTRIBUTIONS  
(Add Line 6a + Line 6b)

(7.) \$ -

**EXPENDITURES**

8. Expenditures

a. Itemized Direct Expenditures (Schedule 4B, Column 7)

(8a.) \$ 84.08 ✓

b. Itemized Get-Out-The Vote (Schedule 4B-G, Column 6)

(8b.) \$

c. In-Kind Expenditures - Purchase of Goods or Services  
(Schedule 4B-2, Column 7)

(8c.) \$

d. Unitemized Expenditures (\$50.00 or less - no Schedule)

(8d.) \$

e. Subtotal of Expenditures

\* (8e.) \$

9. Independent Expenditures (Schedule 4B-1, Column 7)

(9.) \$

10. TOTAL EXPENDITURES (Add Line 8e + Line 9)

(10.) \$ 84.08 ✓

**IN-KIND EXPENDITURES**

11. Total In-Kind Expenditures-Endorsements, Donations or  
Loans of Goods or Services (Schedule 4B-2, Column 8)

(11.) \$

**DEBTS AND OBLIGATIONS**

12. Debts and Obligations

a. Owed by the Committee (Schedule 4E)

(12a.) \$

b. Owed to the Committee (Schedule 4E)

(12b.) \$

Column II  
Cumulative for Election Cycle

(18.) \$

(19.) \$

(20.) \$

(21.) \$

(22.) \$

(23.) \$

(24.) \$

(25.) \$

**BALANCE STATEMENT**

13. Ending Balance of last report filed  
(Enter zero if no previous reports have been filed.)

(13.) \$ - ✓

14. Amount received during reporting period  
(Line 5, Column I, Total Contributions & Other Receipts)

(14.) + 5630.00 ✓

15. SUBTOTAL Add lines 13 and 14

(15.) = 5630.00 ✓

16. Amount expended during reporting period  
(Line 10, Column I, Total Expenditures)

(16.) - 84.08 ✓

17. ENDING BALANCE  
(Subtract line 16 from line 15)

(17.) \$ 5545.92 ✓

\*If your ending balance is negative, please recheck your math.



MICHIGAN DEPARTMENT OF STATE  
BUREAU OF ELECTIONS

ITEMIZED CONTRIBUTIONS  
SCHEDULE 4A  
BALLOT QUESTION COMMITTEE

1. Committee I.D. Number 144097  
2. Committee Name Kids First Campaign

Please enter contributors name and address. If contribution is from an individual, enter last name, first name, middle initial.		6. Amount	7. Cumulative for Election Cycle for Each Contributor (Through date of receipt)
3. Contribution # 1 Name & Address: <u>Obermyer, Ginger</u> <u>215 East Drive</u> <u>Marshall, MI 49068</u>		4. Date of Receipt <u>8/26/21</u> \$ <u>5.00</u>	\$ <u>5.00</u> <a href="#">Click Here for Memo Itemization</a>
5. If over \$100.00 cumulative, please provide: Occupation _____ Employer _____ Business Address _____ Type of Contribution: <input checked="" type="checkbox"/> Direct <input type="checkbox"/> Loan from a person <input type="checkbox"/> Fund Raiser			
3. Contribution # 2 Name & Address: <u>Davis, Vivian</u> <u>901 Huntington Blvd</u> <u>Albion, MI 49224</u>		4. Date of Receipt <u>9/29/21</u> \$ <u>50.00</u>	\$ <u>50.00</u> <a href="#">Click Here for Memo Itemization</a>
5. If over \$100.00 cumulative, please provide: Occupation _____ Employer _____ Business Address _____ Type of Contribution: <input checked="" type="checkbox"/> Direct <input type="checkbox"/> Loan from a person <input type="checkbox"/> Fund Raiser			
3. Contribution # 3 Name & Address: <u>Stewart, Ian</u> <u>515 Schuyler</u> <u>Marshall, MI 49068</u>		4. Date of Receipt <u>9/30/21</u> \$ <u>25.00</u>	\$ <u>25.00</u> <a href="#">Click Here for Memo Itemization</a>
5. If over \$100.00 cumulative, please provide: Occupation _____ Employer _____ Business Address _____ Type of Contribution: <input checked="" type="checkbox"/> Direct <input type="checkbox"/> Loan from a person <input type="checkbox"/> Fund Raiser			
3. Contribution # 4 Name & Address: <u>Jennifer Conley Darling</u> <u>505 North Madison</u> <u>Marshall, MI 49068</u>		4. Date of Receipt <u>9/30/21</u> \$ <u>50.00</u>	\$ <u>50.00</u> <a href="#">Click Here for Memo Itemization</a>
5. If over \$100.00 cumulative, please provide: Occupation <u>Self employed</u> Employer <u>Self employed</u> Business Address <u>505 North Madison Marshall, MI 49068</u> Type of Contribution: <input checked="" type="checkbox"/> Direct <input type="checkbox"/> Loan from a person <input type="checkbox"/> Fund Raiser			

Page Subtotal

130.00

Grand Total of All Schedules 4A  
(Complete on last page of Schedule)

130.00

Enter this total  
on line 3a of  
Summary  
Page



MICHIGAN DEPARTMENT OF STATE  
BUREAU OF ELECTIONS

ITEMIZED CONTRIBUTIONS  
SCHEDULE 4A  
BALLOT QUESTION COMMITTEE

1. Committee I.D. Number 144097

2. Committee Name Kids First Campaign

Please enter contributors name and address. If contribution is from an individual, enter last name, first name, middle initial.		6. Amount	7. Cumulative for Election Cycle for Each Contributor (Through date of receipt)
<p>3. Contribution # 1 Name &amp; Address: <u>Skidmore, Erin</u> <u>515 Schuyler</u> <u>Marshall, MI 49068</u></p> <p>4. Date of Receipt <u>9/30/21</u></p> <p>5. If over \$100.00 cumulative, please provide: Occupation _____ Employer _____ Business Address _____ Type of Contribution: <input checked="" type="checkbox"/> Direct <input type="checkbox"/> Loan from a person <input type="checkbox"/> Fund Raiser</p>		\$ <u>5.00</u>	\$ <u>5.00</u>
		<a href="#">Click Here for Memo Itemization</a>	
<p>3. Contribution # 2 Name &amp; Address: <u>Egnatuk, Tara</u> <u>320 North Linden</u> <u>Marshall, MI 49068</u></p> <p>4. Date of Receipt <u>9/30/21</u></p> <p>5. If over \$100.00 cumulative, please provide: Occupation _____ Employer _____ Business Address _____ Type of Contribution: <input checked="" type="checkbox"/> Direct <input type="checkbox"/> Loan from a person <input type="checkbox"/> Fund Raiser</p>		\$ <u>50.00</u>	\$ <u>50.00</u>
		<a href="#">Click Here for Memo Itemization</a>	
<p>3. Contribution # 3 Name &amp; Address: <u>Reed, Katy</u> <u>425 N Division St</u> <u>Marshall, MI 49068</u></p> <p>4. Date of Receipt <u>9/30/21</u></p> <p>5. If over \$100.00 cumulative, please provide: Occupation _____ Employer _____ Business Address _____ Type of Contribution: <input checked="" type="checkbox"/> Direct <input type="checkbox"/> Loan from a person <input type="checkbox"/> Fund Raiser</p>		\$ <u>5.00</u>	\$ <u>5.00</u>
		<a href="#">Click Here for Memo Itemization</a>	
<p>3. Contribution # 4 Name &amp; Address: <u>Schneitman, Ian</u> <u>737 Green St</u> <u>Marshall, MI 49068</u></p> <p>4. Date of Receipt <u>9/30/21</u></p> <p>5. If over \$100.00 cumulative, please provide: Occupation _____ Employer _____ Business Address _____ Type of Contribution: <input checked="" type="checkbox"/> Direct <input type="checkbox"/> Loan from a person <input type="checkbox"/> Fund Raiser</p>		\$ <u>10.00</u>	\$ <u>10.00</u>
		<a href="#">Click Here for Memo Itemization</a>	

Page Subtotal

70.00

Grand Total of All Schedules 4A  
(Complete on last page of Schedule)

Enter this total  
on line 3a of  
Summary  
Page



MICHIGAN DEPARTMENT OF STATE  
BUREAU OF ELECTIONS

ITEMIZED CONTRIBUTIONS  
SCHEDULE 4A  
BALLOT QUESTION COMMITTEE

1. Committee I.D. Number 144097  
2. Committee Name Kids First Campaign

Please enter contributors name and address. If contribution is from an individual, enter last name, first name, middle initial.		6. Amount	7. Cumulative for Election Cycle for Each Contributor (Through date of receipt)
<p>3. Contribution # 1 Name &amp; Address: <u>Underhill, Ryan</u> <u>811 E Green St</u> <u>Marshall, MI 45068</u></p> <p>4. Date of Receipt <u>9/30/21</u></p> <p>5. If over \$100.00 cumulative, please provide: Occupation _____ Employer _____ Business Address _____ Type of Contribution: <input checked="" type="checkbox"/> Direct <input type="checkbox"/> Loan from a person <input type="checkbox"/> Fund Raiser</p>		<p>\$ <u>20.00</u> \$ <u>20.00</u></p> <p>Click Here for Memo Itemization</p>	
<p>3. Contribution # 2 Name &amp; Address: <u>Steve &amp; Kathy Seales, Steve &amp; Kathy</u> <u>14932 W Michigan Ave</u> <u>Marshall, MI 45068</u></p> <p>4. Date of Receipt <u>9/30/21</u></p> <p>5. If over \$100.00 cumulative, please provide: Occupation _____ Employer _____ Business Address _____ Type of Contribution: <input checked="" type="checkbox"/> Direct <input type="checkbox"/> Loan from a person <input type="checkbox"/> Fund Raiser</p>		<p>\$ <u>25.00</u> \$ <u>25.00</u></p> <p>Click Here for Memo Itemization</p>	
<p>3. Contribution # 3 Name &amp; Address: <u>Mike Olia, Mike</u> <u>707 Huntington Blvd</u> <u>Albion, MI 49224</u></p> <p>4. Date of Receipt <u>9/30/21</u></p> <p>5. If over \$100.00 cumulative, please provide: Occupation _____ Employer _____ Business Address _____ Type of Contribution: <input checked="" type="checkbox"/> Direct <input type="checkbox"/> Loan from a person <input type="checkbox"/> Fund Raiser</p>		<p>\$ <u>100.00</u> \$ <u>100.00</u></p> <p>Click Here for Memo Itemization</p>	
<p>3. Contribution # 4 Name &amp; Address: <u>Allen, Derek</u> <u>524 W Green St</u> <u>Marshall, MI 45068</u></p> <p>4. Date of Receipt <u>9/30/21</u></p> <p>5. If over \$100.00 cumulative, please provide: Occupation _____ Employer _____ Business Address _____ Type of Contribution: <input checked="" type="checkbox"/> Direct <input type="checkbox"/> Loan from a person <input type="checkbox"/> Fund Raiser</p>		<p>\$ <u>100.00</u> \$ <u>100.00</u></p> <p>Click Here for Memo Itemization</p>	

Page Subtotal

245.00

Grand Total of All Schedules 4A  
(Complete on last page of Schedule)

Enter this total  
on line 3a of  
Summary  
Page





MICHIGAN DEPARTMENT OF STATE  
BUREAU OF ELECTIONS

ITEMIZED CONTRIBUTIONS  
SCHEDULE 4A  
BALLOT QUESTION COMMITTEE

1. Committee I.D. Number 144097  
2. Committee Name Kids First Campaign

Please enter contributors name and address. If contribution is from an individual, enter last name, first name, middle initial.		6. Amount	7. Cumulative for Election Cycle for Each Contributor (Through date of receipt)
<p>3. Contribution # 1 Name &amp; Address: <u>Middleton, Lisa</u> <u>92 Knistin Dr</u> <u>Marshall, MI 48068</u></p> <p>4. Date of Receipt <u>9/30/21</u></p> <p>5. If over \$100.00 cumulative, please provide: Occupation _____ Employer _____ Business Address _____ Type of Contribution: <input checked="" type="checkbox"/> Direct <input type="checkbox"/> Loan from a person <input type="checkbox"/> Fund Raiser</p>		<p>\$ <u>50.00</u> : <u>50.00</u></p> <p>Click Here for Memo Itemization</p>	
<p>3. Contribution # 2 Name &amp; Address: <u>Neidlinger, Tom &amp; Darlene</u> <u>7221 Monroe Rd</u> <u>Springport, MI 49284</u></p> <p>4. Date of Receipt <u>9/30/21</u></p> <p>5. If over \$100.00 cumulative, please provide: Occupation _____ Employer _____ Business Address _____ Type of Contribution: <input checked="" type="checkbox"/> Direct <input type="checkbox"/> Loan from a person <input type="checkbox"/> Fund Raiser</p>		<p>\$ <u>75.00</u> : <u>75.00</u></p> <p>Click Here for Memo Itemization</p>	
<p>3. Contribution # 3 Name &amp; Address: <u>Davis, Matt</u> <u>708 Wright Lane</u> <u>Marshall, MI 48068</u></p> <p>4. Date of Receipt <u>9/30/21</u></p> <p>5. If over \$100.00 cumulative, please provide: Occupation _____ Employer _____ Business Address _____ Type of Contribution: <input checked="" type="checkbox"/> Direct <input type="checkbox"/> Loan from a person <input type="checkbox"/> Fund Raiser</p>		<p>\$ <u>100.00</u> : <u>100.00</u></p> <p>Click Here for Memo Itemization</p>	
<p>3. Contribution # 4 Name &amp; Address: <u>Williams, Eddie</u> <u>704 Orchard Dr</u> <u>Albion, MI 48024</u></p> <p>4. Date of Receipt <u>10/1/21</u></p> <p>5. If over \$100.00 cumulative, please provide: Occupation _____ Employer _____ Business Address _____ Type of Contribution: <input checked="" type="checkbox"/> Direct <input type="checkbox"/> Loan from a person <input type="checkbox"/> Fund Raiser</p>		<p>\$ <u>20.00</u> : <u>20.00</u></p> <p>Click Here for Memo Itemization</p>	

Page Subtotal

245.00

Grand Total of All Schedules 4A  
(Complete on last page of Schedule)

Enter this total  
on line 3a of  
Summary  
Page



MICHIGAN DEPARTMENT OF STATE  
BUREAU OF ELECTIONS

ITEMIZED CONTRIBUTIONS  
SCHEDULE 4A  
BALLOT QUESTION COMMITTEE

1. Committee I.D. Number 144097

2. Committee Name Kids First Campaign

Please enter contributors name and address. If contribution is from an individual, enter last name, first name, middle initial.		6. Amount	7. Cumulative for Election Cycle for Each Contributor (Through date of receipt)
3. Contribution # 1 Name & Address: <u>McFadden, Laura</u> <u>17250 H Dr S</u> <u>Marshall, MI 49068</u>		4. Date of Receipt <u>10/1/21</u> \$ <u>10.00</u>	\$ <u>10.00</u> <a href="#">Click Here for Memo Itemization</a>
5. If over \$100.00 cumulative, please provide: Occupation _____ Employer _____ Business Address _____ Type of Contribution: <input checked="" type="checkbox"/> Direct <input type="checkbox"/> Loan from a person <input type="checkbox"/> Fund Raiser			
3. Contribution # 2 Name & Address: <u>Stucky, Jim</u> <u>501 Sibley Lane</u> <u>Marshall, MI 49068</u>		4. Date of Receipt <u>10/1/21</u> \$ <u>50.00</u>	\$ <u>50.00</u> <a href="#">Click Here for Memo Itemization</a>
5. If over \$100.00 cumulative, please provide: Occupation _____ Employer _____ Business Address _____ Type of Contribution: <input checked="" type="checkbox"/> Direct <input type="checkbox"/> Loan from a person <input type="checkbox"/> Fund Raiser			
3. Contribution # 3 Name & Address: <u>Finn, Kelly</u> <u>302 Perry Street</u> <u>Marshall, MI 49068</u>		4. Date of Receipt <u>10/1/21</u> \$ <u>100.00</u>	\$ <u>100.00</u> <a href="#">Click Here for Memo Itemization</a>
5. If over \$100.00 cumulative, please provide: Occupation _____ Employer _____ Business Address _____ Type of Contribution: <input checked="" type="checkbox"/> Direct <input type="checkbox"/> Loan from a person <input type="checkbox"/> Fund Raiser			
3. Contribution # 4 Name & Address: <u>Stulberg, Don</u> <u>508 Orchard Rd</u> <u>Marshall, MI 49068</u>		4. Date of Receipt <u>10/1/21</u> \$ <u>40.00</u>	\$ <u>40.00</u> <a href="#">Click Here for Memo Itemization</a>
5. If over \$100.00 cumulative, please provide: Occupation _____ Employer _____ Business Address _____ Type of Contribution: <input checked="" type="checkbox"/> Direct <input type="checkbox"/> Loan from a person <input type="checkbox"/> Fund Raiser			

Page Subtotal

200.00

Grand Total of All Schedules 4A  
(Complete on last page of Schedule)

Enter this total  
on line 3a of  
Summary  
Page



MICHIGAN DEPARTMENT OF STATE  
BUREAU OF ELECTIONS

ITEMIZED CONTRIBUTIONS  
SCHEDULE 4A  
BALLOT QUESTION COMMITTEE

1. Committee I.D. Number 144099  
2. Committee Name Kids First Campaign

Please enter contributors name and address. If contribution is from an individual, enter last name, first name, middle initial.		6. Amount	7. Cumulative for Election Cycle for Each Contributor (Through date of receipt)
3. Contribution # 1 Name & Address: <u>Piemert, Dave</u> <u>412 Elizabeth St</u> <u>Albion, MI 49224</u>		4. Date of Receipt <u>10/1/21</u> \$ <u>100.00</u> \$ <u>100.00</u>	
5. If over \$100.00 cumulative, please provide: Occupation _____ Employer _____ Business Address _____ Type of Contribution: <input checked="" type="checkbox"/> Direct <input type="checkbox"/> Loan from a person <input type="checkbox"/> Fund Raiser		Click Here for Memo Itemization	
3. Contribution # 2 Name & Address: <u>Worster, Bill</u> <u>102 E Michigan Ave</u> <u>Marshall, MI 49068</u>		4. Date of Receipt <u>10/1/21</u> \$ <u>15.00</u> \$ <u>15.00</u>	
5. If over \$100.00 cumulative, please provide: Occupation _____ Employer _____ Business Address _____ Type of Contribution: <input checked="" type="checkbox"/> Direct <input type="checkbox"/> Loan from a person <input type="checkbox"/> Fund Raiser		Click Here for Memo Itemization	
3. Contribution # 3 Name & Address: <u>Lessner, Raymond</u> <u>223 N Michigan Ave</u> <u>Marshall, MI 49068</u>		4. Date of Receipt <u>10/1/21</u> \$ <u>10.00</u> \$ <u>10.00</u>	
5. If over \$100.00 cumulative, please provide: Occupation _____ Employer _____ Business Address _____ Type of Contribution: <input checked="" type="checkbox"/> Direct <input type="checkbox"/> Loan from a person <input type="checkbox"/> Fund Raiser		Click Here for Memo Itemization	
3. Contribution # 4 Name & Address: <u>Fuller, Kaitlin</u> <u>811 Orchard Dr</u> <u>Marshall, MI 49068</u>		4. Date of Receipt <u>10/2/21</u> \$ <u>5.00</u> \$ <u>5.00</u>	
5. If over \$100.00 cumulative, please provide: Occupation _____ Employer _____ Business Address _____ Type of Contribution: <input checked="" type="checkbox"/> Direct <input type="checkbox"/> Loan from a person <input type="checkbox"/> Fund Raiser		Click Here for Memo Itemization	

Page Subtotal 130.00

Grand Total of All Schedules 4A  
(Complete on last page of Schedule)

Enter this total  
on line 3a of  
Summary  
Page



MICHIGAN DEPARTMENT OF STATE  
BUREAU OF ELECTIONS

ITEMIZED CONTRIBUTIONS  
SCHEDULE 4A  
BALLOT QUESTION COMMITTEE

1. Committee I.D. Number

144097

2. Committee Name

Kids First Campaign

Please enter contributors name and address. If contribution is from an individual, enter last name, first name, middle initial.

6. Amount

7. Cumulative for  
Election Cycle for Each  
Contributor (Through  
date of receipt)

3. Contribution # 1

4. Date of Receipt

10/2/21

Name & Address:

Fuller, Kyle  
811 Orchard  
Marshall, MI 49068

\$ 5.00 5.00

Click Here for Memo Itemization

5. If over \$100.00 cumulative, please provide:

Occupation \_\_\_\_\_ Employer \_\_\_\_\_

Business Address \_\_\_\_\_

Type of Contribution:



Direct



Loan from a person



Fund Raiser

3. Contribution # 2

4. Date of Receipt

10/4/21

Name & Address:

Thompson II, John  
752 Wright Lane  
Marshall, MI 49068

\$ 25.00 25.00

Click Here for Memo Itemization

5. If over \$100.00 cumulative, please provide:

Occupation \_\_\_\_\_ Employer \_\_\_\_\_

Business Address \_\_\_\_\_

Type of Contribution:



Direct



Loan from a person



Fund Raiser

3. Contribution # 3

4. Date of Receipt

10/5/21

Name & Address:

Huggest, Don  
315 North Madison  
Marshall, MI 49068

\$ 20.00 20.00

Click Here for Memo Itemization

5. If over \$100.00 cumulative, please provide:

Occupation \_\_\_\_\_ Employer \_\_\_\_\_

Business Address \_\_\_\_\_

Type of Contribution:



Direct



Loan from a person



Fund Raiser

3. Contribution # 4

4. Date of Receipt

10/8/21

Name & Address:

Clare - Closson, Lori  
536 CosmoPolitan  
Marshall, MI 49068

\$ 20.00 20.00

Click Here for Memo Itemization

5. If over \$100.00 cumulative, please provide:

Occupation \_\_\_\_\_ Employer \_\_\_\_\_

Business Address \_\_\_\_\_

Type of Contribution:



Direct



Loan from a person



Fund Raiser

Page Subtotal

70.00

Grand Total of All Schedules 4A  
(Complete on last page of Schedule)

Enter this total  
on line 3a of  
Summary  
Page





MICHIGAN DEPARTMENT OF STATE  
BUREAU OF ELECTIONS

ITEMIZED CONTRIBUTIONS  
SCHEDULE 4A  
BALLOT QUESTION COMMITTEE

1. Committee I.D. Number 44097

2. Committee Name Kids First Campaign

Please enter contributors name and address. If contribution is from an individual, enter last name, first name, middle initial.		6. Amount	7. Cumulative for Election Cycle for Each Contributor (Through date of receipt)
3. Contribution # 1 Name & Address: <u>Lambrix, Kathleen &amp; David</u> <u>546 Hill Rd</u> <u>Marshall, MI 49068</u>	4. Date of Receipt <u>10/8/21</u>	\$ <u>500.00</u>	\$ <u>500.00</u>
5. If over \$100.00 cumulative, please provide: Occupation <u>retired</u> Employer <u>retired</u> ✓		Click Here for Memo Itemization	
Business Address _____ Type of Contribution: <input checked="" type="checkbox"/> Direct <input type="checkbox"/> Loan from a person <input type="checkbox"/> Fund Raiser			
3. Contribution # 2 Name & Address: <u>Eric &amp; Allison Ebnor</u> <u>521 N Kalamazoo</u> <u>Marshall, MI 49068</u>	4. Date of Receipt <u>10/8/21</u>	\$ <u>200.00</u>	\$ <u>200.00</u>
5. If over \$100.00 cumulative, please provide: Occupation <u>Arts administrator</u> Employer <u>Frankie Center</u> ✓		Click Here for Memo Itemization	
Business Address <u>241 North Mason</u> Type of Contribution: <input checked="" type="checkbox"/> Direct <input type="checkbox"/> Loan from a person <input type="checkbox"/> Fund Raiser			
3. Contribution # 3 Name & Address: <u>Arnold Linkard</u> <u>68 Friendship Lane</u> <u>Marshall, MI 49068</u>	4. Date of Receipt <u>10/9/21</u>	\$ <u>250.00</u>	\$ <u>250.00</u>
5. If over \$100.00 cumulative, please provide: Occupation <u>Chief executive officer</u> Employer <u>Battle Creek Area Assoc. of Realtors</u> ✓		Click Here for Memo Itemization	
Business Address <u>7100 Tower Road Battle Creek, MI 49618</u> Type of Contribution: <input checked="" type="checkbox"/> Direct <input type="checkbox"/> Loan from a person <input type="checkbox"/> Fund Raiser			
3. Contribution # 4 Name & Address: <u>Josh Linkard</u> <u>68 Friendship Lane</u> <u>Marshall, MI 49068</u>	4. Date of Receipt <u>10/9/21</u>	\$ <u>250.00</u>	\$ <u>250.00</u>
5. If over \$100.00 cumulative, please provide: Occupation <u>Chief of Police</u> Employer <u>City of Marshall</u> ✓		Click Here for Memo Itemization	
Business Address <u>323 W. Michigan Ave Marshall, MI 49068</u> Type of Contribution: <input checked="" type="checkbox"/> Direct <input type="checkbox"/> Loan from a person <input type="checkbox"/> Fund Raiser			

Page Subtotal

1200

Grand Total of All Schedules 4A  
(Complete on last page of Schedule)

Enter this total  
on line 3a of  
Summary  
Page



MICHIGAN DEPARTMENT OF STATE  
BUREAU OF ELECTIONS

ITEMIZED CONTRIBUTIONS  
SCHEDULE 4A  
BALLOT QUESTION COMMITTEE

1. Committee I.D. Number 144097  
2. Committee Name Kids First Campaign

Please enter contributors name and address. If contribution is from an individual, enter last name, first name, middle initial.		6. Amount	7. Cumulative for Election Cycle for Each Contributor (Through date of receipt)
<p>3. Contribution # 1 Name &amp; Address: <u>Egnatyle, Debbie &amp; Ivan</u> <u>610 Hill Rd</u> <u>Marshall, MI 49668</u></p> <p>4. Date of Receipt <u>10/9/21</u></p> <p>5. If over \$100.00 cumulative, please provide: Occupation _____ Employer _____ Business Address _____ Type of Contribution: <input checked="" type="checkbox"/> Direct <input type="checkbox"/> Loan from a person <input type="checkbox"/> Fund Raiser</p>		<p>\$ <u>100.00</u> \$ <u>100.00</u></p> <p>Click Here for Memo Itemization</p>	
<p>3. Contribution # 2 Name &amp; Address: <u>Shedd, John</u> <u>1001 South Locust Lane</u> <u>Albion, MI 49224</u></p> <p>4. Date of Receipt <u>10/10/21</u></p> <p>5. If over \$100.00 cumulative, please provide: Occupation _____ Employer _____ Business Address _____ Type of Contribution: <input checked="" type="checkbox"/> Direct <input type="checkbox"/> Loan from a person <input type="checkbox"/> Fund Raiser</p>		<p>\$ <u>100.00</u> \$ <u>100.00</u></p> <p>Click Here for Memo Itemization</p>	
<p>3. Contribution # 3 Name &amp; Address: <u>Trever, Ryan</u> <u>115 W Michigan Ave</u> <u>Marshall, MI 49668</u></p> <p>4. Date of Receipt <u>10/11/21</u></p> <p>5. If over \$100.00 cumulative, please provide: Occupation <u>Owner</u> Employer <u>Blue Fish Consulting</u> ✓ Business Address <u>115 W Michigan Ave Marshall, MI 49668</u> Type of Contribution: <input checked="" type="checkbox"/> Direct <input type="checkbox"/> Loan from a person <input type="checkbox"/> Fund Raiser</p>		<p>\$ <u>125.00</u> \$ <u>125.00</u></p> <p>Click Here for Memo Itemization</p>	
<p>3. Contribution # 4 Name &amp; Address: <u>Conley-Dorling, Jennifer</u> <u>505 North Madison</u> <u>Marshall, MI 49668</u></p> <p>4. Date of Receipt <u>10/15/21</u></p> <p>5. If over \$100.00 cumulative, please provide: Occupation <u>Self employed</u> Employer <u>Self employed</u> ✓ Business Address <u>505 North Madison Marshall, MI 49668</u> Type of Contribution: <input type="checkbox"/> Direct <input type="checkbox"/> Loan from a person <input type="checkbox"/> Fund Raiser</p>		<p>\$ <u>1000.00</u> \$ <u>1050.00</u> ✓</p> <p>Click Here for Memo Itemization</p>	

Page Subtotal

1325.00

Grand Total of All Schedules 4A  
(Complete on last page of Schedule)

Enter this total  
on line 3a of  
Summary  
Page



MICHIGAN DEPARTMENT OF STATE  
BUREAU OF ELECTIONS

ITEMIZED CONTRIBUTIONS  
SCHEDULE 4A  
BALLOT QUESTION COMMITTEE

1. Committee I.D. Number 144097  
2. Committee Name Kids First Campaign

Please enter contributors name and address. If contribution is from an individual, enter last name, first name, middle initial.

3. Contribution #	4. Date of Receipt	6. Amount	7. Cumulative for Election Cycle for Each Contributor (Through date of receipt)
-------------------	--------------------	-----------	---

3. Contribution # 1 Name & Address: <u>Finn, Kelly</u> <u>300 Perry St</u> <u>Albion, MI 49004</u>	4. Date of Receipt <u>10/15/21</u>	\$ <u>50.00</u>	\$ <u>50.00</u>
5. If over \$100.00 cumulative, please provide: Occupation _____ Employer _____ Business Address _____ Type of Contribution: <input checked="" type="checkbox"/> Direct <input type="checkbox"/> Loan from a person <input type="checkbox"/> Fund Raiser			

[Click Here for Memo Itemization](#)

3. Contribution # 2 Name & Address: <u>Seibert, Danielle</u> <u>21406 Division Dr</u> <u>Marshall, MI 49068</u>	4. Date of Receipt <u>10/15/21</u>	\$ <u>50.00</u>	\$ <u>50.00</u>
5. If over \$100.00 cumulative, please provide: Occupation _____ Employer _____ Business Address _____ Type of Contribution: <input checked="" type="checkbox"/> Direct <input type="checkbox"/> Loan from a person <input type="checkbox"/> Fund Raiser			

[Click Here for Memo Itemization](#)

3. Contribution # 3 Name & Address: <u>Davis, Randy</u> <u>576 Orchard Rd</u> <u>Marshall, MI 49068</u>	4. Date of Receipt <u>10/15/21</u>	\$ <u>200.00</u>	\$ <u>200.00</u>
5. If over \$100.00 cumulative, please provide: Occupation <u>retired</u> Employer <u>retired</u> Business Address _____ Type of Contribution: <input checked="" type="checkbox"/> Direct <input type="checkbox"/> Loan from a person <input type="checkbox"/> Fund Raiser			

[Click Here for Memo Itemization](#)

3. Contribution # 4 Name & Address: <u>Bartshoe, Lauren</u> <u>1206 Crescent Dr</u> <u>Albion, MI 49024</u>	4. Date of Receipt <u>10/15/21</u>	\$ <u>50.00</u>	\$ <u>50.00</u>
5. If over \$100.00 cumulative, please provide: Occupation _____ Employer _____ Business Address _____ Type of Contribution: <input checked="" type="checkbox"/> Direct <input type="checkbox"/> Loan from a person <input type="checkbox"/> Fund Raiser			

[Click Here for Memo Itemization](#)

Page Subtotal

350.00

Grand Total of All Schedules 4A  
(Complete on last page of Schedule)



MICHIGAN DEPARTMENT OF STATE  
BUREAU OF ELECTIONS

ITEMIZED CONTRIBUTIONS  
SCHEDULE 4A  
BALLOT QUESTION COMMITTEE

1. Committee I.D. Number 144097  
2. Committee Name Kids First Campaign

Please enter contributors name and address. If contribution is from an individual, enter last name, first name, middle initial.		6. Amount	7. Cumulative for Election Cycle for Each Contributor (Through date of receipt)
3. Contribution # 1 Name & Address: <u>Loughnag, Clare</u> <u>50 Kristin</u> <u>Moshell, MI 48668</u>		4. Date of Receipt <u>10/15/21</u> \$ <u>100.00</u> \$ <u>100.00</u>	Click Here for Memo Itemization
5. If over \$100.00 cumulative, please provide: Occupation _____ Employer _____ Business Address _____ Type of Contribution: <input checked="" type="checkbox"/> Direct <input type="checkbox"/> Loan from a person <input type="checkbox"/> Fund Raiser			
3. Contribution # 2 Name & Address: <u>Mattson, AJ</u> <u>4922 Kellogg Court</u> <u>Albion, MI 48224</u>		4. Date of Receipt <u>10/15/21</u> \$ <u>5.00</u> \$ <u>5.00</u>	Click Here for Memo Itemization
5. If over \$100.00 cumulative, please provide: Occupation _____ Employer _____ Business Address _____ Type of Contribution: <input checked="" type="checkbox"/> Direct <input type="checkbox"/> Loan from a person <input type="checkbox"/> Fund Raiser			
3. Contribution # 3 Name & Address: <u>ARSH Parker, Arshawn</u> <u>210 Monroe St</u> <u>Albion, MI 48224</u>		4. Date of Receipt <u>10/15/21</u> \$ <u>50.00</u> \$ <u>50.00</u>	Click Here for Memo Itemization
5. If over \$100.00 cumulative, please provide: Occupation _____ Employer _____ Business Address _____ Type of Contribution: <input checked="" type="checkbox"/> Direct <input type="checkbox"/> Loan from a person <input type="checkbox"/> Fund Raiser			
3. Contribution # 4 Name & Address: <u>Duckwell, Mary</u> <u>514 North Dune West</u> <u>Moshell, MI 48668</u>		4. Date of Receipt <u>10/15/21</u> \$ <u>10.00</u> \$ <u>10.00</u>	Click Here for Memo Itemization
5. If over \$100.00 cumulative, please provide: Occupation _____ Employer _____ Business Address _____ Type of Contribution: <input checked="" type="checkbox"/> Direct <input type="checkbox"/> Loan from a person <input type="checkbox"/> Fund Raiser			

Page Subtotal 165.00

Grand Total of All Schedules 4A  
(Complete on last page of Schedule)

Enter this total  
on line 3a of  
Summary  
Page





MICHIGAN DEPARTMENT OF STATE  
BUREAU OF ELECTIONS

ITEMIZED CONTRIBUTIONS  
SCHEDULE 4A  
BALLOT QUESTION COMMITTEE

1. Committee I.D. Number 144091  
2. Committee Name Kids First Campaign

Please enter contributors name and address. If contribution is from an individual, enter last name, first name, middle initial.		6. Amount	7. Cumulative for Election Cycle for Each Contributor (Through date of receipt)
<p>3. Contribution # 1 Name &amp; Address: <u>Kingscott</u> <u>259 East Michigan Ave 308</u> <u>Kalamazoo, MI 49001</u></p> <p>4. Date of Receipt <u>10/15/21</u></p> <p>5. If over \$100.00 cumulative, please provide: Occupation <u>president</u> Employer <u>see above</u> ✓</p> <p>Business Address _____</p> <p>Type of Contribution: <input checked="" type="checkbox"/> Direct <input type="checkbox"/> Loan from a person <input type="checkbox"/> Fund Raiser</p>		<p>\$ <u>500.00</u> \$ <u>500.00</u></p> <p><a href="#">Click Here for Memo Itemization</a></p>	
<p>3. Contribution # 2 Name &amp; Address: <u>Abbott, Thomas, Mauldin, Patrick Bear PIC</u> <u>304 South Jackson Street</u> <u>Jackson, MI 49201</u></p> <p>4. Date of Receipt <u>10/16/21</u></p> <p>5. If over \$100.00 cumulative, please provide: Occupation <u>lawyer</u> Employer <u>see above</u> ✓</p> <p>Business Address _____</p> <p>Type of Contribution: <input checked="" type="checkbox"/> Direct <input type="checkbox"/> Loan from a person <input type="checkbox"/> Fund Raiser</p>		<p>\$ <u>1000.00</u> \$ <u>1000.00</u></p> <p><a href="#">Click Here for Memo Itemization</a></p>	
<p>3. Contribution # 3 Name &amp; Address: _____</p> <p>4. Date of Receipt _____</p> <p>5. If over \$100.00 cumulative, please provide: Occupation _____ Employer _____</p> <p>Business Address _____</p> <p>Type of Contribution: <input type="checkbox"/> Direct <input type="checkbox"/> Loan from a person <input type="checkbox"/> Fund Raiser</p>		<p>\$ _____ \$ _____</p> <p><a href="#">Click Here for Memo Itemization</a></p>	
<p>3. Contribution # 4 Name &amp; Address: _____</p> <p>4. Date of Receipt _____</p> <p>5. If over \$100.00 cumulative, please provide: Occupation _____ Employer _____</p> <p>Business Address _____</p> <p>Type of Contribution: <input type="checkbox"/> Direct <input type="checkbox"/> Loan from a person <input type="checkbox"/> Fund Raiser</p>		<p>\$ _____ \$ _____</p> <p><a href="#">Click Here for Memo Itemization</a></p>	

Page Subtotal

Grand Total of All Schedules 4A  
(Complete on last page of Schedule)

1500.00

5430.00

Enter this total  
on line 3a of  
Summary  
Page



MICHIGAN DEPARTMENT OF STATE  
BUREAU OF ELECTIONS

ITEMIZED DIRECT EXPENDITURES  
SCHEDULE 4B  
BALLOT QUESTION COMMITTEE

1. Committee I. D. Number

144097

2. Committee Name

Kids First Campaign

3. Name and address of person to whom paid	4. State purpose of expenditure. 5. Identify the ballot proposal involved. Indicate whether supported or opposed.	6. Date	7. Amount	8. Cumulative for election
<b>Expenditure # 1</b>				
Name & Address:  Strike, Inc 510 Townsend St San Francisco, CA 94103	4. Purpose: <u>Fees for online payments</u> 5. Ballot Proposal: <u>Marshall PS bond</u> County: <u>Calhoun</u>	<u>10/15/21</u> Date of Expenditure	<u>\$ 84.08</u>	<u>\$ 84.08</u>
<input type="checkbox"/> Check box if expenditure is payment of debt or obligation reported on previous statement	<input checked="" type="checkbox"/> Support <input type="checkbox"/> Oppose <input type="checkbox"/> Statewide <input type="checkbox"/> Local	Click for Memo Itemization Type		
<b>Expenditure # 2</b>				
Name & Address:	4. Purpose:	5. Ballot Proposal:	\$	\$
		Date of Expenditure		
County:	Click for Memo Itemization Type			
<input type="checkbox"/> Check box if expenditure is payment of debt or obligation reported on previous statement	<input type="checkbox"/> Support <input type="checkbox"/> Oppose <input type="checkbox"/> Statewide <input type="checkbox"/> Local			
<b>Expenditure # 3</b>				
Name & Address:	4. Purpose:	5. Ballot Proposal:	\$	\$
		Date of Expenditure		
County:	Click for Memo Itemization Type			
<input type="checkbox"/> Check box if expenditure is payment of debt or obligation reported on previous statement	<input type="checkbox"/> Support <input type="checkbox"/> Oppose <input type="checkbox"/> Statewide <input type="checkbox"/> Local			
<b>Expenditure # 4</b>				
Name & Address:	4. Purpose:	5. Ballot Proposal:	\$	\$
		Date of Expenditure		
County:	Click for Memo Itemization Type			
<input type="checkbox"/> Check box if expenditure is payment of debt or obligation reported on previous statement	<input type="checkbox"/> Support <input type="checkbox"/> Oppose <input type="checkbox"/> Statewide <input type="checkbox"/> Local			
<b>Expenditure # 4</b>				
Name & Address:	4. Purpose:	5. Ballot Proposal:	\$	\$
		Date of Expenditure		
County:	Click for Memo Itemization Type			
<input type="checkbox"/> Check box if expenditure is payment of debt or obligation reported on previous statement	<input type="checkbox"/> Support <input type="checkbox"/> Oppose <input type="checkbox"/> Statewide <input type="checkbox"/> Local			
<b>Expenditure # 4</b>				
Name & Address:	4. Purpose:	5. Ballot Proposal:	\$	\$
		Date of Expenditure		
County:	Click for Memo Itemization Type			
<input type="checkbox"/> Check box if expenditure is payment of debt or obligation reported on previous statement	<input type="checkbox"/> Support <input type="checkbox"/> Oppose <input type="checkbox"/> Statewide <input type="checkbox"/> Local			

Subtotal this page

84.08

Grand Total of Schedules 4B  
(Complete on last page of Schedule)

Enter this total  
on Line 8a of  
the Summary  
Page

# omen Albion

agh the Albion region."  
9 guidelines restrict-  
AAPW gained over 10  
the pandemic support  
aking 2020 the largest  
APW was founded in  
ell and the late Maggie  
V members have given  
Albion area nonprofit

always welcome. The  
at women have a heart  
to make the Albion area  
embers need not live in  
AAPW supporters live  
rly send checks to sup-  
group's efforts.

ion contact AAPW vol-  
Roush at nancyroush@  
at gtabb5858@yahoo.  
at mstarkey74@gmail.

# chool funds

to continue to support  
ere are several good  
the local United Way,  
asons include that do-  
d Homer specific pro-  
g decisions are made  
or lists are never shared  
nd payroll deductions

always be mailed to  
5, Albion, MI 49224,  
albionhomeruw.org or  
at 517-499-2563.

re Carolyn Amos, Don-  
rdette, David Diemert,  
in Hopkins, Art Kale,  
huler, Gary Tompkins,  
ane Williamson.

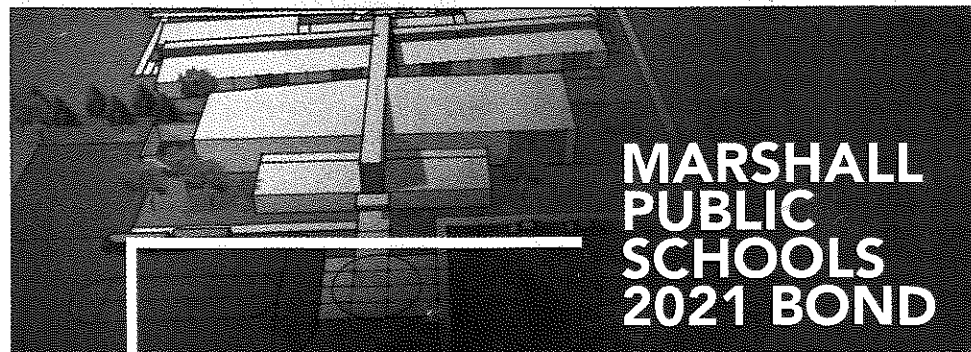

**\$45,580,000 Million**

Albion taxpayers will experience a tax  
increase of 3 mills, whereas Marshall  
taxpayers will continue paying 7.05 mills.

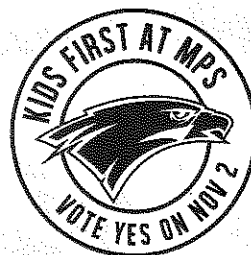

## VOTE "YES" ON NOV 2ND!

Those of us who are parents, grandparents, uncles, aunts,  
big brothers, big sisters, foster parents, mentors, etc. want  
the children we love and care about to have plenty of  
opportunities to thrive. A good place to start is by  
providing them with access to safe and up-to-date  
facilities, grounds, technology, and equipment in learning  
environments that will prepare them for the world of  
tomorrow. **We believe this bond supports this goal.**

Learn more at **VoteKidsFirst.com**

Paid for by the Kids First Committee

**NEWS TIPS?** Call The Recorder at 517-629-0041 or email  
information to [therecorder@frontiernet.net](mailto:therecorder@frontiernet.net).

# Marshall

nce of having the providers you need right in your community. Our certified  
rics & Gynecology Specialists in Marshall provide a wide range of services for  
ding annual check-ups, gynecologic care, pregnancy and childbirth, and more.

intment.

**BRONSON**  
Obstetrics &  
Gynecology Specialists

121; S. Martinez 687; S. 561; M. West 561; C. Diver 678; B. Hill 670; J. Garber 536; S. Parks 524; S. Hutchings 664; T. Saylor Hutchings 507; J. Razkowic 652; M. Miller 633; L. 502; N. Main 497; T. George

10; Speedy Chick 9; Livin' on a Spare 7.5; Borderline Professionals 7; Here

Kingsbury 609; R. A White 534; Trumbull 5 E. Rowell 484; T. Ho Dawn The B Dizzy Pins Sassy Lass High Baklund 149; J. Mat High S 426; S. Day 366. Moose TBC Spare Ribs 5; Stealy Four 5; Martinez & Frogs 3; T Incredibow

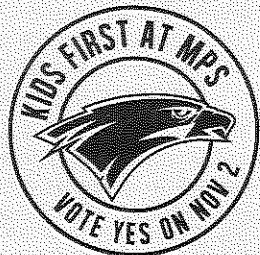
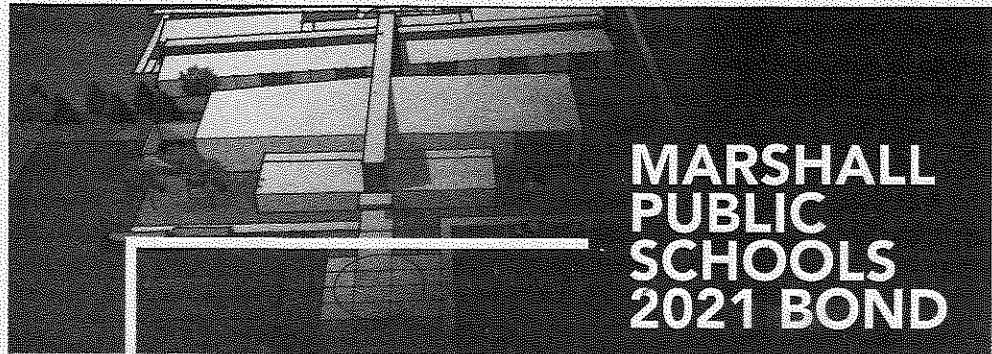

# VOTE "YES" ON NOV 2ND!

Those of us who are parents, grandparents, uncles, aunts, big brothers, big sisters, foster parents, mentors, etc. want the children we love and care about to have plenty of opportunities to thrive. A good place to start is by providing them with access to safe and up-to-date facilities, grounds, technology, and equipment in learning environments that will prepare them for the world of tomorrow. **We believe this bond supports this goal.**

Learn more at **VoteKidsFirst.com**

Paid for by the Kids First Committee

Ad-Visor Chronicle 9 Oct 2021



## **The Marshall Public Schools 2021 Bond includes an all-new K-5 elementary school in Albion.**

We're proud of the youth in Albion. With enrollment at Harrington Elementary currently at capacity, this means that the Albion community is growing and full of potential. Passing the Marshall Public Schools 2021 Bond means that Albion children will have access to a state-of-the-art facility – the newest in the district.



### **Features include:**

- 56,000 square feet
- Upper and lower elementary playground equipment
- Separate bus and student drop off zones
- General & special education classrooms
- Media center
- Art room
- Music room
- Gymnasium
- Cafeteria

### **Passing the 2021 bond means:**

- \$16,920,000 will be put back into the Albion community in the form of a new school.
- Families of Albion will have access to a modern educational environment that's close to home.
- Albion taxpayers will experience a tax increase of 3.0 mills, whereas Marshall taxpayers will continue paying 7.05 mills.

**VOTE "YES" NOVEMBER 2, 2021 | [VoteKidsFirst.com](http://VoteKidsFirst.com)**

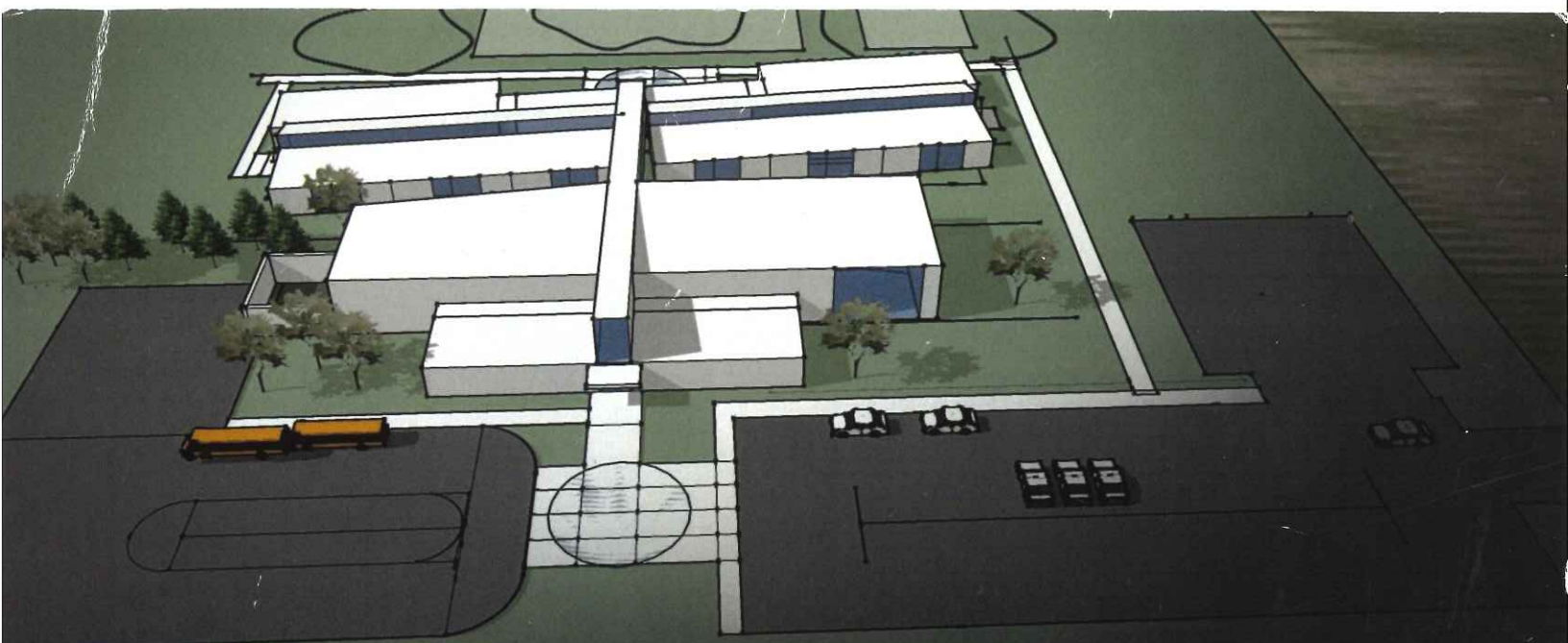

**VOTE "YES" NOVEMBER 2**  
**VoteKidsFirst.com**



STATE OF MICHIGAN  
JOCELYN BENSON, SECRETARY OF STATE  
DEPARTMENT OF STATE  
LANSING

February 9, 2022

Ginger Obermeyer  
215 East Drive  
Marshall, MI 49068

Re: *Atchison v. Obermeyer*  
Campaign Finance Complaint No. 2021-11-67-26

Dear Ms. Obermeyer,

The Department of State (Department) has received a formal complaint filed against you by David Atchison. The complaint alleges that you violated the Michigan Campaign Finance Act (MCFA or ACT) by submitting inaccurate campaign statements in your role as treasurer for the Kids First Ballot Question committee by failing to report campaign expenditures.

In Michigan, ballot question committees registered under the MCFA are required to file campaign statements reporting contributions and expenditures. MCL 226(1). A contribution is “a payment, gift, subscription, assessment, expenditure, contract, payment for services, dues, advance, forbearance, loan, or donation of money or anything of ascertainable monetary value, or a transfer of anything of ascertainable monetary value to a person, made for the purpose of influencing . . . the qualification, passage, or defeat of a ballot question.” MCL 169.204(1). An expenditure is “a payment, donation, loan, or promise of payment of money or anything of ascertainable monetary value for goods, materials, services, or facilities in assistance of, or in opposition to . . . the qualification, passage, or defeat of a ballot question.” MCL. 169.206(1). A knowing omission or under-report of contributions or expenditures may be punishable by “a civil fine of not more than \$1,000.00 or the amount of the contributions and expenditures omitted or underreported, whichever is greater.” MCL 169.233(11).<sup>1</sup>

The purpose of this letter is to inform you of the Department’s examination of these matters and of your right to respond to the allegations before the Department proceeds further. It is important to understand that the Department is neither making this complaint nor accepting the allegations as true. The investigation and resolution of this complaint are governed by section 15 of the Act

---

<sup>1</sup> The Department notes that the filing official is responsible for determining issues of substantial compliance when they accept the campaign statement. MCL 169.216(6). This means that, while the Department will investigate complaints alleging unreported or under-reported contributions or expenditures, the Department will not investigate complaints alleging de minimis mistakes in contributor names, reported addresses, or similar issues.

and the corresponding administrative rules, R 169.51 *et seq.* An explanation of the investigation process is enclosed with this letter and a copy is available on the Department's [website](#).

**If you wish to file a written response to this complaint, you are required to do so within 15 business days of the date of this letter.** Your response may include any written statement or additional documentary evidence you wish to submit.

All materials must be sent to the Department of State, Bureau of Elections, Richard H. Austin Building, 1<sup>st</sup> Floor, 420 West Allegan Street, Lansing, Michigan 48918. Materials should also be sent via email to [Elections@Michigan.gov](mailto:Elections@Michigan.gov) given the ongoing pandemic. If you fail to submit a response, the Department will render a decision based on the evidence furnished by the complainant.

A copy of your answers will be provided to Mr. Atchison, who will have an opportunity to submit a rebuttal statement to the Department. After reviewing all the statements and materials provided by the parties, the Department will determine whether “there may be reason to believe that a violation of [the MCFA] has occurred.” MCL 169.215(10).

Sincerely,

Adam Fracassi  
Regulatory Manager  
Bureau of Elections

To Whom It May Concern:

I am writing in response to the letter I received dated February 9, 2022 in regards to a formal complaint filed against me by David Atchison. First, I did not knowingly file an incomplete or inaccurate Pre-Election Campaign finance report. Additionally I am willing to amend, or correct anything that is in fact incorrect, but nothing was done intentionally. I volunteered to fill out paperwork for my kids schools VOTE YES bond committee. I have never done this and filled it out to the best of my ability. Since in Mr. Atchison's complaint it is number, I will try to respond to each number.

1. I am not employed and was not employed by Calhoun Intermediate Schools at the time of this. I answered Block 6 as my personal address because that was the address the Kids First Committee used and I thought that is what it was asking for.
2. I do not completely know what this point is saying, but I did not knowingly leave off expenditures. I included everything we had invoices for at the time of filling out the paperwork.
3. I used the form we received from Stripe.com to show what people listed as their name and address. Ian Schnaiman is listed as Ian Schnaitman, as you can see in the attached document.
4. I used the form we received from Stripe.com to show what people listed as their name and address. Mae Olla is listed as Mae Olla, as you can see in the attached document.
5. Kingscott Associates was who donated the \$500. In an email from Teri Lowe she told me to include an occupation for the company. I filled it out to the best of my ability.

6-15. We were working with a third party, BluFish for help with the advertising. The committee had not received an invoice or estimate of any kind at the time of me filling out the Pre-Election. I don't know how I was supposed to fill it out if I had no idea of an actual expense. The Post-Election form does have this information on it.

16. I had no idea this was a Kids First expense and did not receive an invoice before filling out the Pre or Post election forms.

17. We were working with a third party, BluFish for help with the advertising. The committee had not received an invoice or estimate of any kind at the time of me filling out the Pre-Election. I don't know how I was supposed to fill it out if I had no idea of an actual expense. The Post-Election form does have this information on it.

I was a little shocked at the nastiness and work that went into trying to volunteer for my kids school. I have never experienced anything like it. I have never done this before and after the nastiness we have endured, I likely will not again. Again, I am willing to amend any record the Bureau of Elections asks me to. I would like to just close the committee out with the proper reports and be done with this. Additionally, I would like to add that throughout the entire report my last name is spelled incorrectly. It is Obermyer, not Obermeyer, as Mr. Atchison has in the complaint. Please let me know if you have any additional questions or need anything else.

Thank you,

A handwritten signature in black ink, appearing to read 'Ginger Obermyer', with a stylized flourish at the end.

Ginger Obermyer



donate-2021-10-15

Donation Amount	Name (First)	Name (Last)	Address (Street Address)	Address (City)	Address (ZIP / P.O.)	Payment Date	Payment Status
\$50.00	ArShawn	Parker	210 S Monroe St	Albion	49224	10/15/2021 11:18	Paid
<del>\$200.00</del>	Dr. Randy	Davis	576 Orchard Road	Marshall	49068	10/15/2021 11:14	Paid
<del>\$50.00</del>	Danielle	Siebert	21406 Division Drive	Marshall	49068	10/15/2021 11:13	Paid
<del>\$5.00</del>	<del>At-</del>	Mattson	4922 Kellogg Center	Albion	49224	2021-10-15 11:18:54	Paid
<del>\$100.00</del>	Clare	Loughridge	50 Kristin	Marshall	49068	2021-10-15 11:14:52	Paid
<del>\$50.00</del>	Lauren	Bartshe	1206 Crescent Drive	Albion	49224	2021-10-15 11:13:06	Paid
<del>\$50.00</del>	Kelly	Finn	302 Perry Street	Albion	49224	2021-10-15 11:09:28	Paid
<del>\$1,000.00</del>	Jennifer	Conley	565 North Madison	Marshall	49068	2021-10-15 09:03:20	Paid
<del>\$125.00</del>	Ryan	Traver	115 W. MICHIGAN AVE.	MARSHALL	49068	2021-10-11 12:45:20	Paid
<del>\$100.00</del>	John	Shedd	1001 south locust lane	Albion	49224	2021-10-10 17:44:38	Paid
<del>\$500.00</del>	Kathleen and David	Lambrix	546 Hill Rd	Marshall	49068	2021-10-08 11:42:33	Paid
<del>\$20.00</del>	Kori	Kiffe-Closson	536 Cosmopolitan	Marshall	49068	2021-10-08 09:02:44	Paid
<del>\$20.00</del>	Dana	Huggett	315 North Madison	Marshall	49068	2021-10-05 17:23:38	Paid
<del>\$25.00</del>	John	Thompson II	752 Wright Ln	Marshall	49068-9612	2021-10-04 09:54:17	Paid
<del>\$5.00</del>	Kyle	Fuller	811 Orchard Dr	Marshall	49015	2021-10-02 13:40:29	Paid
<del>\$5.00</del>	Kaitlin	Fuller	811 Orchard Dr	Marshall	49015	2021-10-02 13:37:40	Paid
<del>\$10.00</del>	Raymond	Lessau	223 N Marshall Ave	Marshall	49068	2021-10-01 17:03:32	Paid
<del>\$15.00</del>	Warner	Ball	102 E Michigan Ave	Marshall	49068	2021-10-01 12:50:53	Paid
<del>\$100.00</del>	Dave	Diemert	412 Elizabeth st	Albion	49224	2021-10-01 09:16:56	Paid
<del>\$40.00</del>	Dan	Stulberg	508 ORCHARD ROAD	MARSHALL	49068	2021-10-01 08:49:29	Paid
<del>\$100.00</del>	Kelly	Finn	302 Perry Street	Albion	49224	2021-10-01 08:17:08	Paid
<del>\$50.00</del>	Jim	Stealy	501 Sibley Lane	Marshall	MI	2021-10-01 06:58:26	Paid
<del>\$10.00</del>	Laura	McFadden	17290 H Drive S	Marshall	49068	2021-10-01 04:53:09	Paid
<del>\$20.00</del>	Eddie	Williams	704 Orchard Dr	Albion	49224	2021-10-01 00:18:42	Paid
<del>\$100.00</del>	Matt	Davis	708 Wright Lane	Marshall	49068	2021-09-30 23:30:03	Paid
<del>\$75.00</del>	Tom & Darlene	Neidlinger	7221 Monroe Rd	Springport	49284	2021-09-30 22:02:09	Paid
<del>\$50.00</del>	Lisa	Middleton	92 Kristin dr	Marshall	49068	2021-09-30 22:01:27	Paid
<del>\$25.00</del>	Steve & Kathy	Searles	14932 W MICHIGAN AVE	MARSHALL	49068	2021-09-30 21:55:59	Paid
<del>\$100.00</del>	Mae	Ola	707 Huntington Blvd	Albion	49224-9404	2021-09-30 21:53:44	Paid
<del>\$100.00</del>	Derek	Allen	524 W Green St.	Marshall	49068	2021-09-30 21:47:29	Paid
<del>\$20.00</del>	Ryan	Underhill	811 E Green St	Marshall	49068	2021-09-30 21:38:10	Paid
<del>\$10.00</del>	Ian	Schnaitman	737 W GREEN STREET	MARSHALL	49068	2021-09-30 20:50:51	Paid
<del>\$5.00</del>	Katy	Reed	425 N. Division St.	Marshall	49068	2021-09-30 20:33:57	Paid
<del>\$50.00</del>	Tara	Egnatuk	320 North Linden	Marshall	49068	2021-09-30 20:25:50	Paid
<del>\$5.00</del>	Erin	Skidmore	515 Schuyler	Marshall	49068	2021-09-30 20:14:35	Paid
<del>\$50.00</del>	Jennifer	Conley Darling	565 North Madison	Marshall	49068	2021-09-30 19:59:22	Paid



STATE OF MICHIGAN  
JOCELYN BENSON, SECRETARY OF STATE  
DEPARTMENT OF STATE  
LANSING

June 10, 2022

David H. Atchison  
108 West Erie Street  
Albion, Michigan 49224

Re: *Atchison v. Obermeyer*  
Campaign Finance Complaint No. 2021-11-67-26

Dear Mr. Atchison:

The Department of State received a response from Ginger Obermeyer to the complaint you filed against them alleging a violation of the Michigan Campaign Finance Act, 1976 P.A. 388, MCL 169.201 *et seq.* A copy of the response is provided as an enclosure with this letter.

You may file a rebuttal statement after reviewing the enclosed response. If you elect to file a rebuttal statement, you are required to do so within 10 business days of the date of this letter. The rebuttal statement may be emailed to [BOERegulatory@michigan.gov](mailto:BOERegulatory@michigan.gov) or mailed to the Department of State, Bureau of Elections, Richard H. Austin Building, 1<sup>st</sup> Floor, 430 West Allegan Street, Lansing, Michigan 48918.

Sincerely,

A handwritten signature in black ink, appearing to read "Adam Fracassi".

Adam Fracassi, Regulatory Manager  
Bureau of Elections  
Michigan Department of State



STATE OF MICHIGAN  
JOCELYN BENSON, SECRETARY OF STATE  
DEPARTMENT OF STATE  
LANSING

September 21, 2022

Ginger Obermyer  
215 East Drive  
Marshall, MI 49068

Re: *Atchison v. Obermyer*  
Campaign Finance Complaint No. 2021-11-67-26

Dear Ms. Obermyer:

The Department of State (Department) has finished investigating the campaign finance complaint filed against you by David Atchison on November 23, 2021. The complaint alleges you violated the Michigan Campaign Finance Act (MCFA or Act) by submitting inaccurate campaign statements in your role as treasurer for the Kids First Ballot Question committee by failing to report campaign expenditures

The complaint alleged a series of violations, largely related to expenditures omitted from your pre-election campaign finance report. First, Mr. Atchison alleged that you incorrectly indicated your residential address on the section of the ballot question committee filing that asked for the treasurer's business address. Second, he listed a series of contributors for whom the pre-election report lists a name other than the contributors' legal name or did not include the full street address. Third, he alleged that expenditures to BluFish Consulting were incorrectly omitted from your pre-election campaign finance report and detailed a series of graphic designs and social media ads that indicated that expenditures must have occurred. Fourth, he stated that you failed to include an expenditure for legal services incurred by the committee, and included a letter form a law firm purporting to represent Kids First as proof of the service.

You responded to the complaint on February 23, 2022. In your response you expressed a willingness to correct any incomplete or inaccurate reports. You indicated that you used your personal address in the section of the form asking for the treasurer's business address as that was the address the Kids First Committee used. You also indicate that you entered the information regarding contributors names and addresses to the best of your knowledge, using the information provided by the contributors on the site used by the committee for contributions. With regard to expenditures, you indicate that the committee was working with a third party, BluFish for help with advertising and that at the time of the pre-election campaign statement you had yet to receive an estimate or invoice from them, so you did not list any expenditures in the pre-election statement. You stated that you did list these expenditures on the committee's post-election filing

once you received the invoice. Finally, you replied that you did not realize that the legal services were a Kids First expense and did not receive an invoice before filling out the pre- or post-election forms.

Mr. Atchison was notified of your response in a letter dated June 13, 2022, and was given the opportunity to provide a rebuttal, but he did not do so.

In Michigan, ballot question committees registered under the MCF A are required to file Campaign statements reporting contributions and expenditures. MCL 169.226(1). A contribution is "a payment, gift, subscription, assessment, expenditure, contract, payment for services, dues, advance, forbearance, loan, or donation of money or anything of ascertainable monetary value, or a transfer of anything of ascertainable monetary value to a person, made for the purpose of influencing ... the qualification, passage, or defeat of a ballot question." MCL 169.204(1). An expenditure is "a payment, donation, loan, or promise of payment of money or anything of ascertainable monetary value for goods, materials, services, or facilities in assistance of, or in opposition to ... the qualification, passage, or defeat of a ballot question." MCL 169.206(1). A knowing omission or under-report of contributions or expenditures may be punishable by "a civil fine of not more than \$1,000.00 or the amount of the contributions and expenditures omitted or under-reported, whichever is greater." MCL 169.233(11).<sup>1</sup>

The Department concludes that there is sufficient evidence to determine that a potential violation of the Act has occurred. First, the Department is satisfied that the expenditures to BluFish were included in your post-election report and dismisses the allegations related to their omission. However, you acknowledge in your response that you did not realize that legal services should have been included in your pre- or post-election report. Because they should have been included, but were not reported, the Department concludes that a potential violation of the Act has occurred.

When the Department finds that there may be reason to believe a violation has occurred, the Act requires the Department to use "informal methods such as a conference [or] conciliation" to correct the potential violation or to prevent further violation. MCL 169.215(10). Statute provides 90 business days for the Department to engage this resolution process. *Id.* If this matter is not resolved within 90 business days, or by January 30, 2023, the Department will have no choice but to proceed with either referral to the Attorney General's office for enforcement of any criminal penalties or commence an administrative hearing against you. *Id.*

Upon review, the Department requests you amend your pre-election report to include your legal expenses. Once you have done so, the Department will issue a warning and consider this matter concluded. Please note that you may be assessed late filing fees by the County. Late-filing fees

---

<sup>1</sup> The Department notes that the filing official is responsible for determining issues of substantial compliance when they accept the campaign statement. MCL 169.216(6). This means that, while the Department will investigate complaints alleging unreported or under-reported contributions or expenditures, the Department will not investigate complaints alleging de minimus mistakes in contributor names, reported addresses, or similar issues.

are assessed and collected by the filing official with whom the statements are filed. MCL 169.217(1). Any questions regarding these late-filing fees should be directed to the County Clerk's office.

If you have any questions, you may contact me by emailing [BOERegulatory@Michigan.gov](mailto:BOERegulatory@Michigan.gov).

Sincerely,

A handwritten signature in blue ink, appearing to read "Adam Fracassi". The signature is fluid and cursive, with the first name "Adam" and last name "Fracassi" clearly distinguishable.

Adam Fracassi, Regulatory Manager  
Regulatory Section  
Bureau of Elections  
Michigan Department of State





STATE OF MICHIGAN  
JOCELYN BENSON, SECRETARY OF STATE  
DEPARTMENT OF STATE  
LANSING

January 31, 2023

The Honorable Dana Nessel  
Department of Attorney General  
G. Mennen Williams Building  
525 West Ottawa Street  
Lansing, MI 48933

Re: *Atchison v. Obermyer*  
Michigan Campaign Finance Complaint

Dear Attorney General Nessel:

Please allow this letter to serve as a referral to the Attorney General of the above referenced campaign finance matter for the enforcement of any criminal penalties under the Michigan Campaign Finance Act. MCL 169.215(10)(a).

If you or your staff would like any additional information regarding this case, please contact this office.

Sincerely

s/ Michael J. Brady

Michael J. Brady, Chief Legal Director  
Michigan Secretary of State

cc: Heather Meingast, Division Chief, CLEE Division